

Soft Track® & Hard Track Parts

Item	Model #	Description (Pads)	Tire Size	Note	Kit (lbs)
2	132FX	13.25" Pad (for Soft Track® & Hard Track)	10.00		11
2	147FX	14.75" Pad (for Soft Track® & Hard Track)	12.00		12
Item	Model #	Description (Soft Track® Shoes) Urethane	Tire Size	Note	
1,2,7,9	132FXSSU	13.25" Pad & Soft Track® Insert	10.00	B	15
1,7	132SSU	13.25" Soft Track® Insert	10.00		3.5
1,2,3,4,5,6,7,9	132FXSSCU	13.25" Soft Track® Pad Complete	10.00	A,B	19.5
1,2,7,9	147FXSSU	14.75" Pad & Soft Track® Insert	12.00	B	16.25
1,7	147SSU	14.75" Soft Track® Insert	12.00		4
1,2,3,4,5,6,7,9	147FXSSCU	14.75" Soft Track® Pad Complete	12.00	A,B	21
Item	Model #	Description (Hard Track Shoes)	Tire Size	Note	
1,2,8,9,10	132FXHS	13.25" Pad & Hard Track Insert	10.00	B,D	17.5
1,8,10	132HS	13.25" Hard Track Insert	10.00	D	6
1,2,3,4,5,6,8,9,10	132FXHSC	13.25" Hard Track Pad Complete	10.00	A,B,D	22.5
1,2,8,9,10	147FXHS	14.75" Pad & Hard Track Insert	12.00	B,D	19.5
1,8,10	147HS	14.75" Hard Track Insert	12.00	D	7
1,2,3,4,5,6,8,9,10	147FXHSC	14.75" Hard Track Pad Complete	12.00	A,B,D	24

Note:

A. Includes 2 Links (7512), 4 Nuts, 4 Bolts, 4 Bushings (8864).

B. Includes Inserts

C. For use on F-track Only.

D. For use on Hard Tracks with replaceable shoes

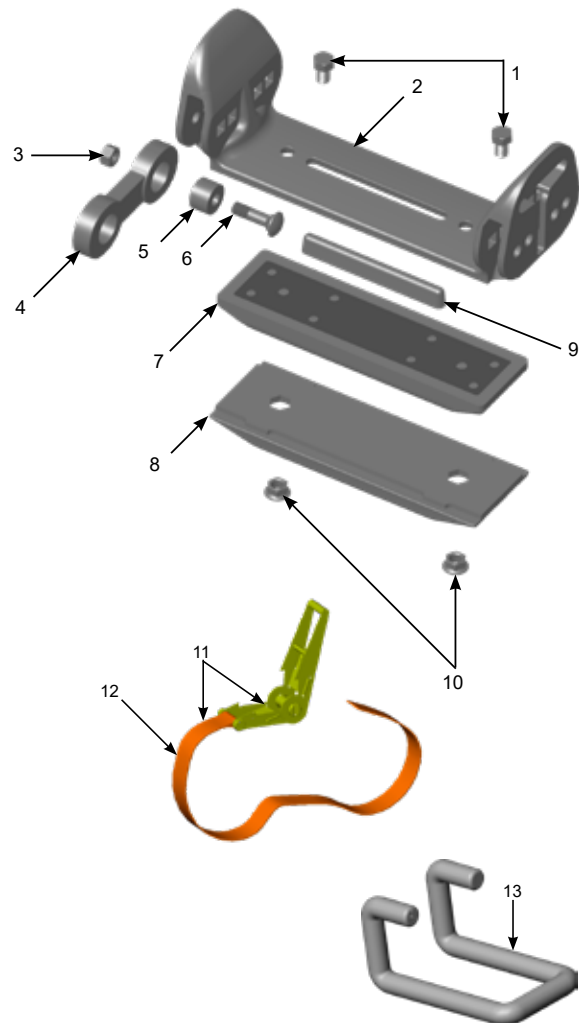
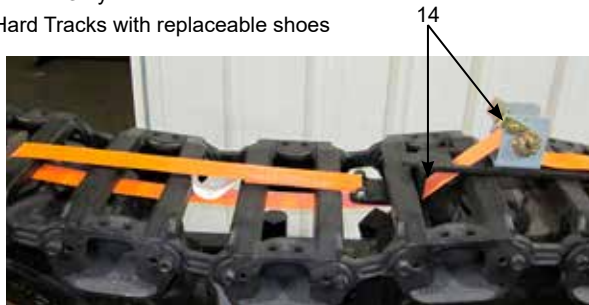

Item	Model #	Description	Note
1	3557	Hard Track & Soft Track® Pad Bolt (1/2" x 1")	
10	3548	1/2" Flange Nut	
9	132LTB	132 Traction Bar	
9	147LTB	147 Traction Bar	
	9502	Short Traction Bar (used on early "EX" pad)	
4	7510	D Link (1" holes) Minimum order 4	
4	7512F	E-F Link (1 1/4" holes) Minimum order 4	
5	8863	D Bushing 1" (O.D.) Minimum order 12	
5	8864	E-F Bushing 1 1/4" (O.D.) Minimum order 12	C
3	8865	C,D,E,F Nut 1/2" NF GR5 center lock Minimum order 24	
6	8866	C,D,E,F Carriage Bolt 1/2"x1 7/8" GR5 Minimum order 24	
11	1586	Standard Track Installation Tool	
12	4818	Standard Strap	
13	4824	Soft Track® & Hard Track Binder Bracket	
14	11350	Optional Track Installation Tool	