



# FH-400 JD 7R IVT

## Undercarriage Installation Instructions

### Caution:

- Always use precaution when working around any equipment.
- Always wear safety glasses.
- Follow tractor manufacturer's safety guidelines when installing this product.
  1. Read all instructions prior to installation.
  2. Remove weights and weight bracket from front of tractor if necessary.
  3. If 1" bolts are not installed in the side plates at the rear of the undercarriage, install a 1" bolt (PN: 16-20562) and a 1" nut (PN: 70-20599) into each of the plates with nuts in them.
  4. Position the undercarriage under the tractor and center with the frame of the tractor.
  5. Lift the U/C until the holes on the front of the tractor tractor line up with the holes on the U/C.
  6. At the front of the tractor, use 4 - 20mm x 70mm bolts (PN: 16-1876) with a 3/4" hardened flat washer (PN: 57-20757) on each bolt to attach the U/C to the front of the tractor. Tighten finger tight. See the attached diagram for any clarification.
  7. Insert 2 - 20mm x 70mm bolts (PN: 16-1876) with a 3/4" flat washer (PN: 57-20747) on each bolt in the front 2 holes on each side of the rear of the undercarriage and the tractor frame. See the attached diagram for any clarification.
  8. Attach the push plate (PN: 44-16780) to the undercarriage and tractor frame with 2 - 20mm x 90mm bolts (PN: 16-1510) with a 3/4" flat washer (PN: 57-20747) on each bolt in the rear 2 holes on each side of the rear of the undercarriage and the tractor frame. **Note orientation of the push plate on the attached diagram.**
  9. Once all bolts are installed, torque the front 20mm bolts to 432 ft-lbs.
  10. Before tightening the rear 20mm x 90mm bolts, use the 1" bolt on each side to push the push plate against the bolts on the tractor frame.
  11. Torque the 1" bolts to 90-95 ft-lbs.
  12. Tighten the 1" nuts up tight against plate on the undercarriage. Use the nuts to lock the bolts in place.
  13. Torque the rear 20mm bolts to 432 ft-lbs.
  14. After first 8 hours of use, re-torque all bolts.
  15. Check all fasteners regularly to ensure proper operation of equipment.

THE INFORMATION CONTAINED IN THIS DRAWING IS THE SOLE PROPERTY OF GROUSER PRODUCTS INC ANY REPRODUCTION IN PART OR WHOLE WITHOUT THE WRITTEN PERMISSION OF GROUSER PRODUCTS INC IS PROHIBITED.

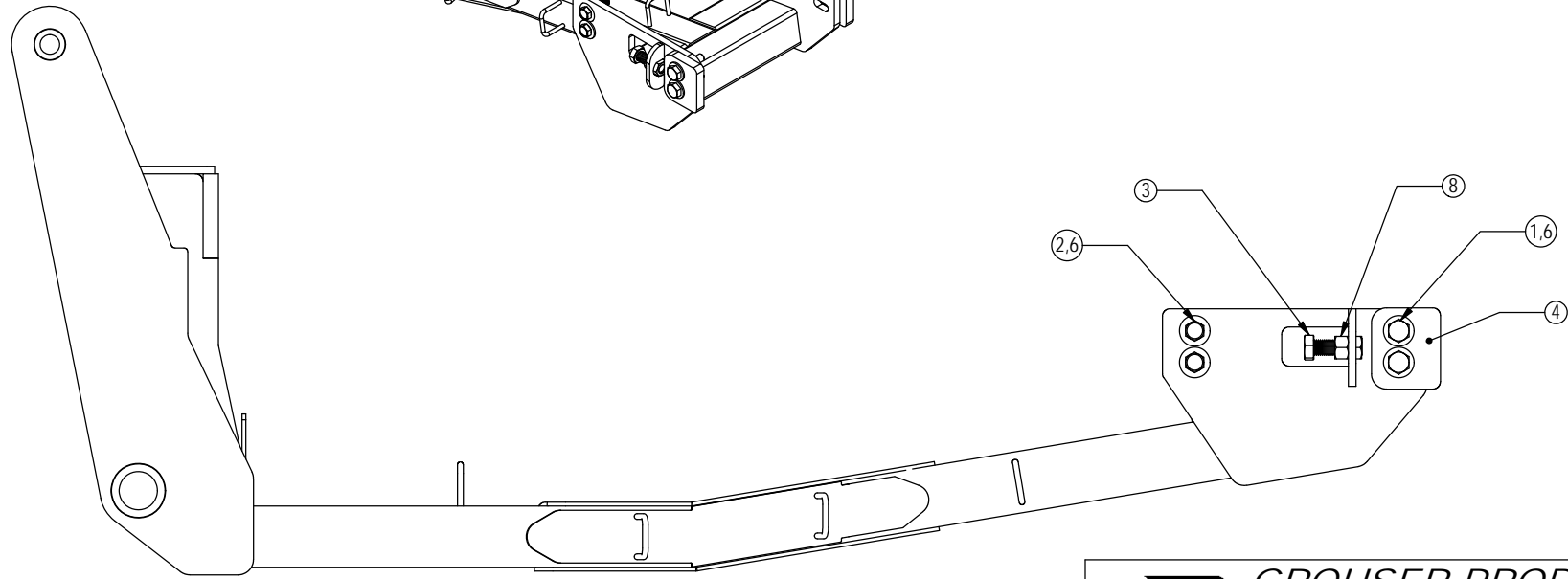
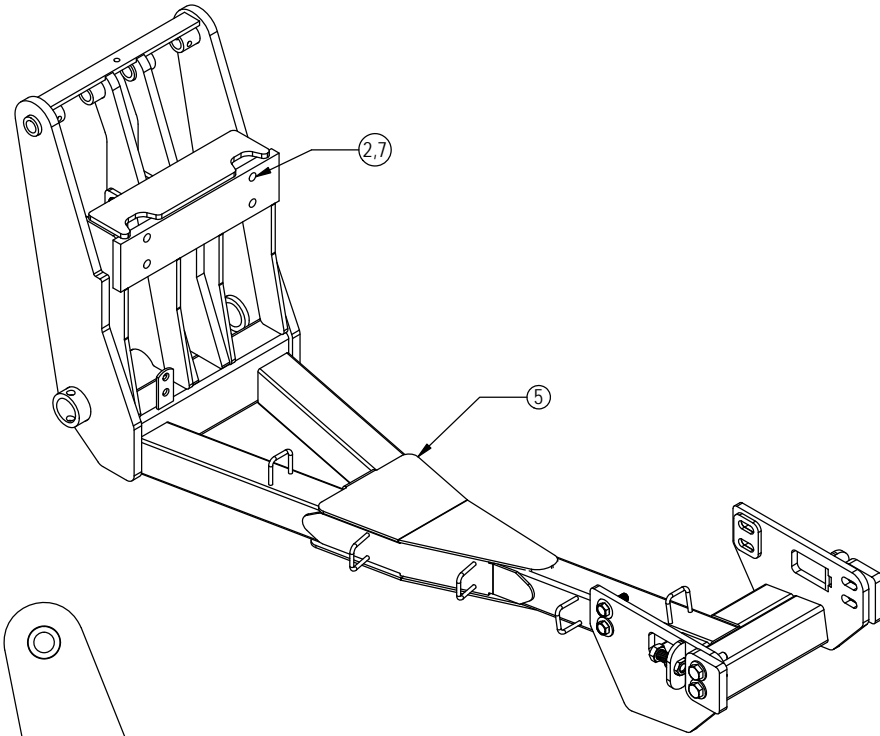

Item No.	Qty.	Part No.	Description
1	4	16-1510	20mm x 2.50mm x 90mm Metric Hex Bolt Gr 10.9 Coarse
2	8	16-1876	20mm x 2.5mm x 70mm Metric Hex Bolt Gr 10.9 Coarse
3	2	16-20562	1" x 3" Hex Bolt Gr 8 NC
4	2	44-16780	JD 7R Push Plate
5	1	54-16775	JD 7R UC - w/IVT
6	8	57-20747	3/4" Flat Washer
7	4	57-20757	3/4" SAE Hardened Flat Washer - 1-1/2" OD
8	2	70-20599	1" Hex Nut



**GROUSER PRODUCTS INC.**

755 2nd Ave NW Phone 701.282.7710  
 West Fargo, ND 58078 Fax 701.282.8131  
 WWW.GROUSER.COM

TITLE: FH-400 U/C- JD 7R

Date: 5/31/2013

DWG. NO.: 16775-A