



JOHN DEERE 9RX

Ag Pro Undercarriage

Installation Instructions

For Models:

JD 9RX: 9470RX, 9520RX, 9570RX, 9620RX

Purchase Date
Serial Number
Model Number
Tractor Model
Dealer

To The Owner

This manual contains information concerning the installation of the undercarriage. You have purchased dependable, long lasting equipment, but only by proper care and operation can you expect to receive the performance and long service built into our products. Please have all operators read this manual carefully and keep the manual available for ready reference. If you have any questions or concerns, contact Grouser Products.

Caution:

- Always use caution when working around any equipment.
- Always wear safety glasses.
- Follow tractor manufacturer's safety guidelines when installing this product.
- Use paint where necessary to prevent rust.
- Do not modify or permit anyone else to modify or alter the equipment and its components without first consulting Grouser Products.

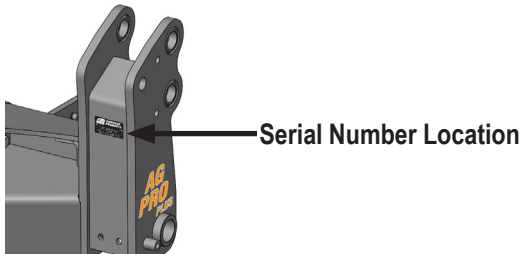

Note:

- When installing hardware, only finger tighten until all hardware is in place.
- A full diagram of the assembly with the full list of parts is on pages 6-7.
- Unstrap and remove any components that are attached for shipping.
- Read all instructions prior to performing installation.
- Tractor frame not shown in some diagrams for clarity.
- The tracks may need to be rotated up or down to gain better access at some bolting locations

Installation

1. If applicable, remove front weights, weight bracket, and toolbox from front of tractor.
2. Remove cable holder behind the front axle if applicable. Keep spacer and washer to reinstall later.

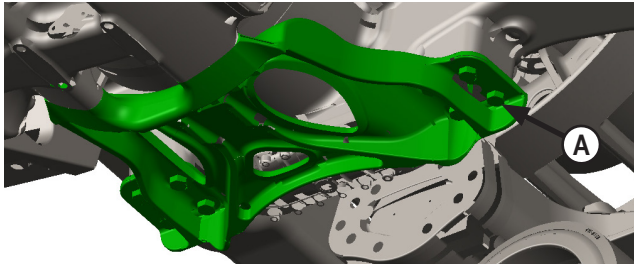

3. If applicable, remove front axle support brackets from front of tractor (A).

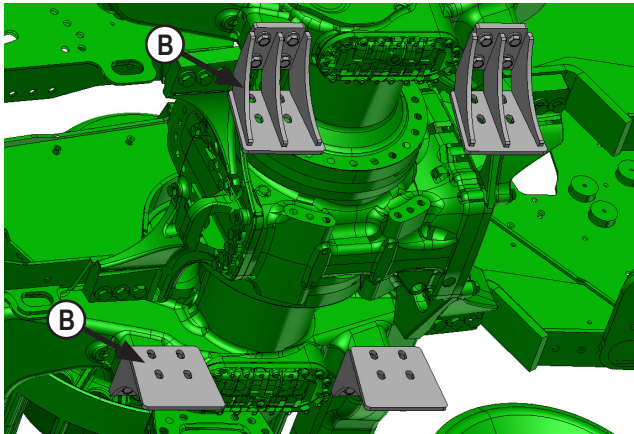

4. Attach the final drive brackets to the final drive with 16 - 20mm x 60mm bolts and 16 - hardened flat washers (B).
5. Push the brackets away from the tractor frame to make room for installing undercarriage.

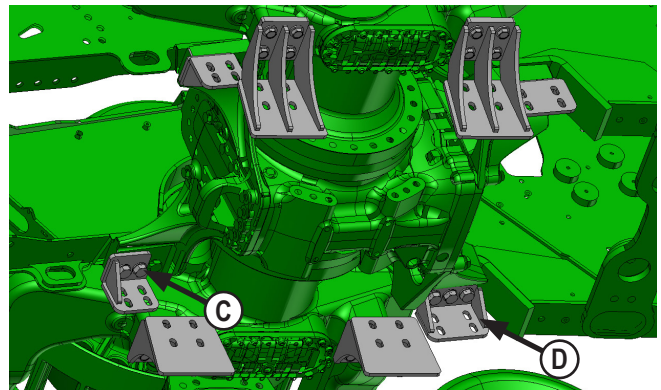

NOTE: The orientation of the left and right front brackets is important. Install the brackets as shown above.

NOTE: When removing the front tractor axle frame bolts, always leave the rear bolt in on each side.

6. Remove the front 2 tractor axle frame bolts on each side and attach the front brackets to the front 2 holes on the tractor frame in front of the axle with 4 - 24mm x 100mm bolts and 4 - 7/8" hardened washers (C).
7. Remove the rear 3 tractor axle frame bolts on each side and attach the rear brackets to the 3 holes on the tractor frame behind the axle with 6 - 24mm x 100mm bolts and 6 - 7/8" hardened washers (D).
8. Push the brackets towards the center to make room for installing undercarriage.

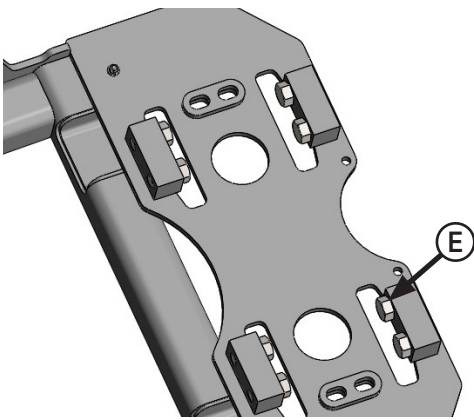

9. Completely thread 8 - 1" x 2" adjustment bolts (E) at rear of undercarriage with heads facing towards each other. The bolts will be adjusted after the undercarriage is installed.

10. Position undercarriage under tractor and center on the frame of the tractor. Lift undercarriage until holes of undercarriage line up with holes in the side of the tractor frame.

NOTE: When lifting the undercarriage, watch for any potential pinching of hoses or any other components to prevent any damage.

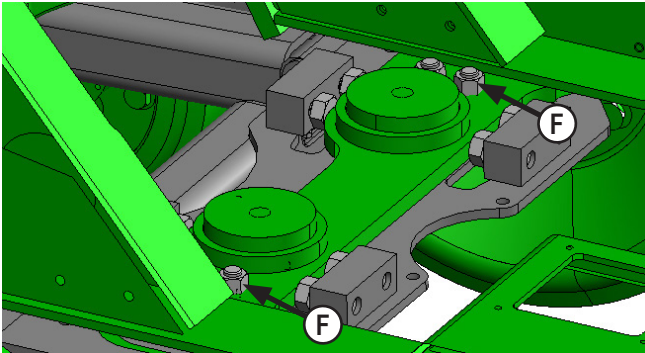

11. Attach the rear of the undercarriage vertically to the cross member on the tractor frame behind the rear axle with 4 - 7/8" x 3" bolts, 8 - 7/8" hardened flat washers, and 4 - 7/8" nuts (F).

NOTE: Add shims between the undercarriage and the tractor frame to reduce any gap if necessary. Use shims until there is a gap of 1/16" or less on the front. See attached diagram for the proper location and orientation of each shim. Do Not put all of the shims on one side of the undercarriage.

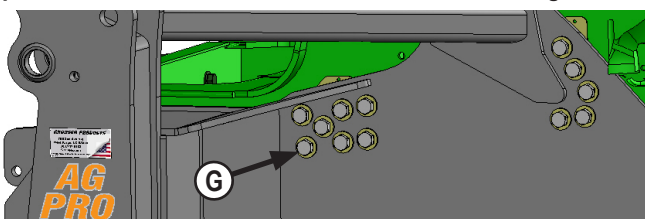

NOTE: Follow Steps #12-16 for the left side. After Step #16, tighten the bolts until they are snug. If necessary, add more shims on right side until a gap of 1/16" or less is on the right side. Proceed with Step #12-16 for the right side.

12. Install 7 - 3/4" x 3-1/2" bolts and 7 - 3/4" hardened HD flat washers (G) through the front holes on each side of the undercarriage, shims, and the tractor frame.

13. Thread each bolt into the front threaded plate. See full assembly diagram on Page 6 for correct orientation of the plate. The side with the notch should be towards the front.

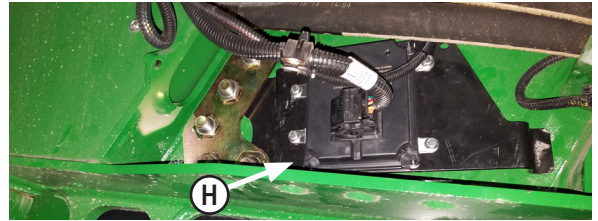

14. If there is a controller for the drive shaft sensor on the left inside frame of the tractor, remove the original hardware and reattach with the new hardware in Step #15-16. Install the controller between the tractor frame and the new nut plate.

15. Install 5 - 3/4" X 3" bolts and 5 - 3/4" hardened HD flat washers (H) through the slots on each side of the undercarriage, shims, and the tractor frame.

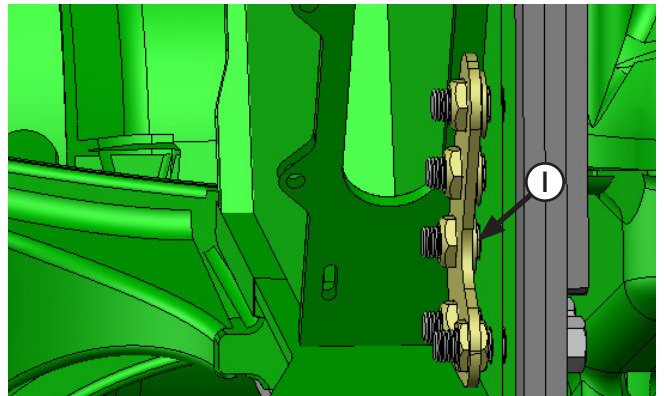

16. Place controller from Step #14 on the bolts and thread a 3/4" flange nut on the top 4 bolts from Step #15. Attach the nut plate to the bottom bolt and line up the top hex nuts to fit in the nut plate (I). Note the orientation of the flange nuts.

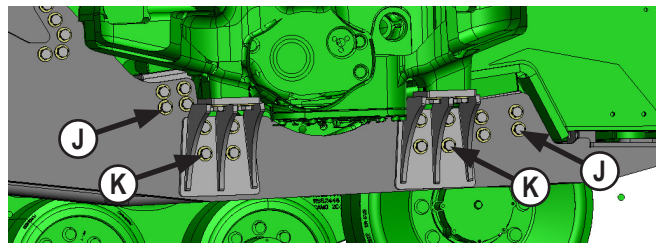

17. Attach the front and rear brackets (J) to the inside of the undercarriage and the final drive brackets (K) to the outside of the undercarriage with a 32 - 3/4" x 2-1/4" bolt, 64 - 3/4" hardened HD flat washers, and 32 - 3/4" nuts.

18. Torque the rear vertical 7/8" bolts (F) to 600 ft-lbs.

19. Torque the front 24 - 3/4" bolts (G & I) to 380 ft-lbs.

20. Torque all of the 3/4" bolts (J & K) attaching the brackets to the undercarriage to 380 ft-lbs. Alternate between the groups of bolts when torquing. For example, torque the front left bracket bolts, the rear right bracket bolts, rear left bracket bolts, front right bracket bolts. Do the same routine for the final drive bracket bolts.

21. Torque the vertical 24mm bolts (C & D) to 909 ft-lbs., and the vertical 20mm bolts (B) to 432 ft-lbs.

NOTE: If available, John Deere service tool JDG650 (shown below) can be used to torque the vertical 24mm bolts.

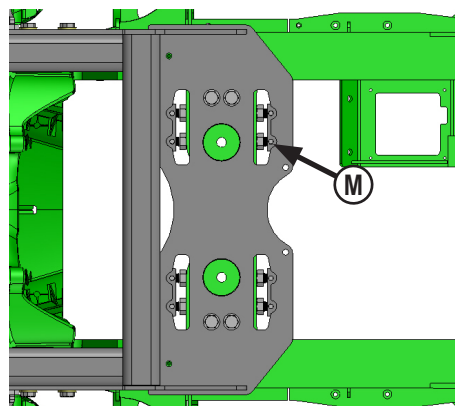

NOTE: View is from underneath the tractor and undercarriage.

23. Install 2 - 5/16" x 3/4" bolts (M) into the blocks at the rear of the undercarriage to lock each 1" x 2" bolt in place. Torque the 5/16" bolts to 19 ft-lbs.

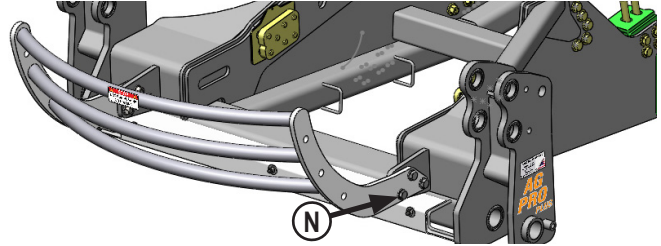

24. Install the grill guard to the front of the undercarriage with 6 - 3/4" x 2-1/2" bolts, 12 - 3/4" flat washers and 6 - 3/4" nuts (N).

25. Torque the 3/4" bolts (T) to 257 ft-lbs.

NOTE: If applicable, refer to Page 5 to attach the front of the tow cable.

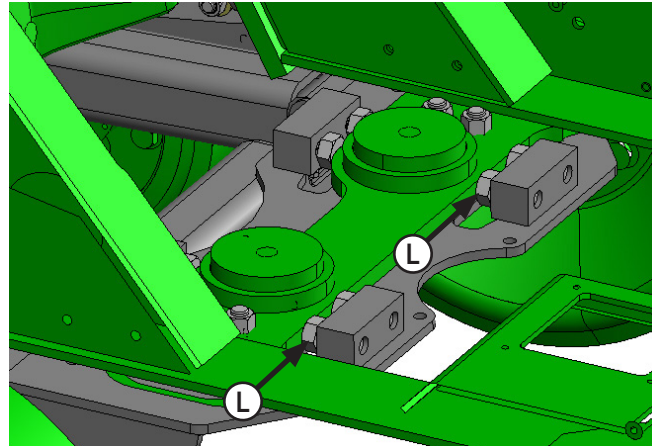

22. Unscrew the 1" x 2" bolts (L) at the rear of the undercarriage until they are tight against the tractor frame. Torque the 1" bolts to 200 ft-lbs.

Hose Routing



1. At the pivot area of the tractor, remove the bolts from the top plate that hold the cylinder pins and install the hose routing bracket along with the original plate and new 12mm flange bolts. Torque the 12mm bolts to 105 ft-lbs (O).

2. Route hoses through the hose loops on the undercarriage until you reach the end of the undercarriage as shown in Step #3.



3. Route the hoses toward the center and attach to the undercarriage with a heavy zip tie (P).

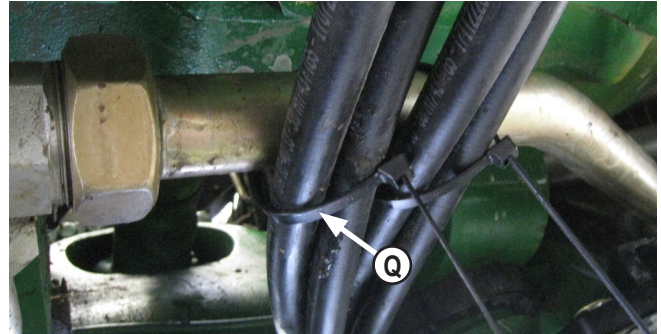

4. Zip tie the hoses to this steel line behind the undercarriage cross member (Q).

5. Route hoses up through the hose loops on the bracket that was installed in Step #1

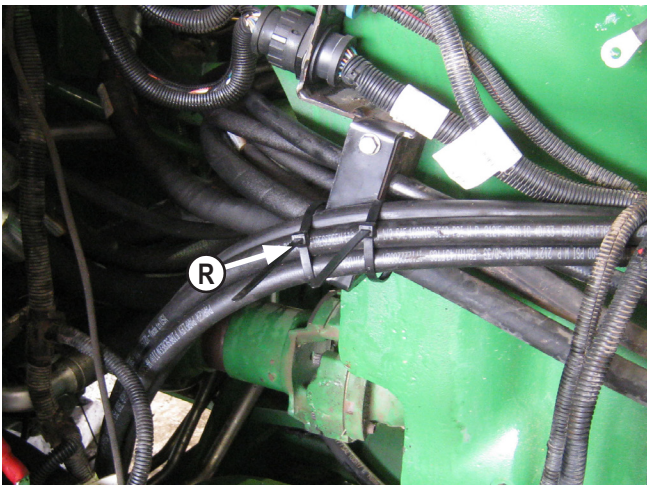

6. Route the hoses upward through the tractor. Staying away from the driveshaft by attaching the hoses to any other steel lines along the way. Attach to the tractor's hoses right by the hose bracket with zip ties (R).



7. Route the hoses through the open cavity of the back section of the tractor. Secure hoses with zip ties where necessary to avoid rubbing and pinch areas. Plug the hoses into the open SCV's at the back of the tractor.

NOTE: The quantity of hoses may vary depending on blade system.

Maintenance

1. After first 8 hours of use, re-torque all bolts.
2. Check all fasteners regularly to ensure proper operation of equipment.
3. Inspect all equipment for existing or potential damages every 10 hours or less.

Tow Cable Support Bracket Assembly

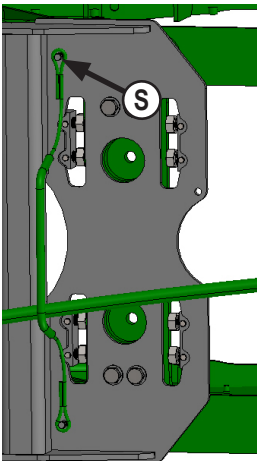

NOTE: Kit (PN: 41788-A) is required if tractor has a tow cable.

1. Reinstall the cable holder with the original spacers and washers and use the new 2 - 3/8" x 1-3/4" bolts, 2 - 3/8" washers and 2 - 3/8" flange nuts at the rear of the undercarriage (S). Torque the bolts to 47 ft-lbs.

NOTE: Original spacers and washers are not shown in the picture.

2. Attach the tow cable bracket and the tow cable as shown below. Torque the 7/8" bolts to 600 ft-lbs.

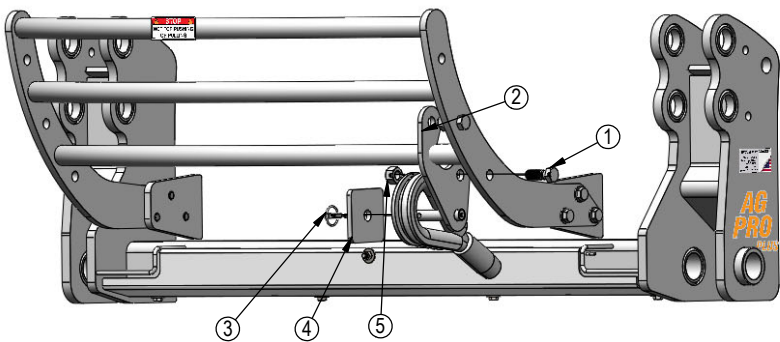

ITEM NO.	QTY.	PART NO.	DESCRIPTION
1	2	16-20540	7/8" x 2-1/2" Hex Bolt Gr 8 NC
2	1	18-41788	Tow Cable Bracket
3	1	43-9360	7/16" x 1-3/4" Lynch Pin
4	1	44-15585	Plate
5	2	70-20598	7/8" Hex Nut Gr 8 NC

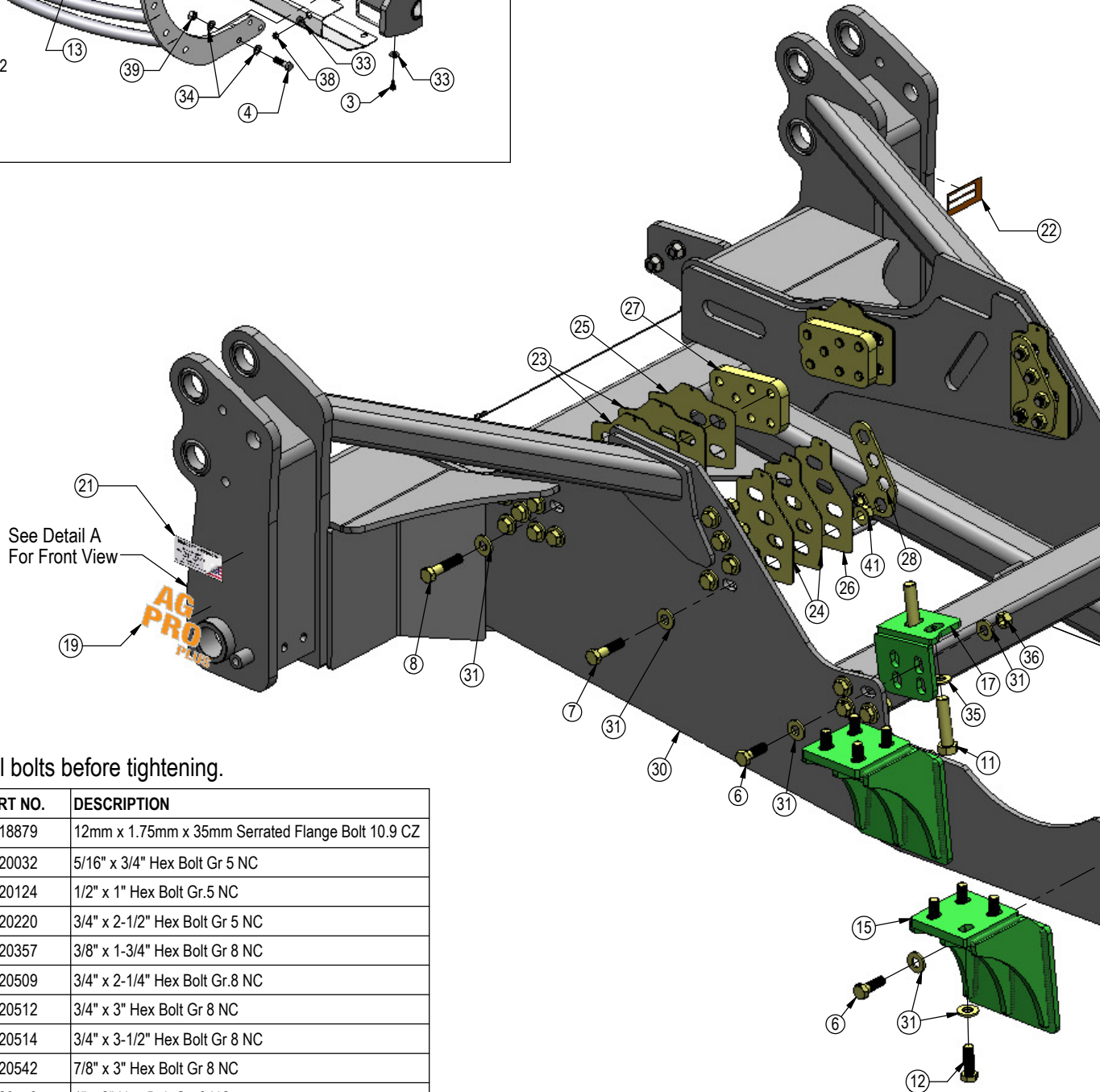
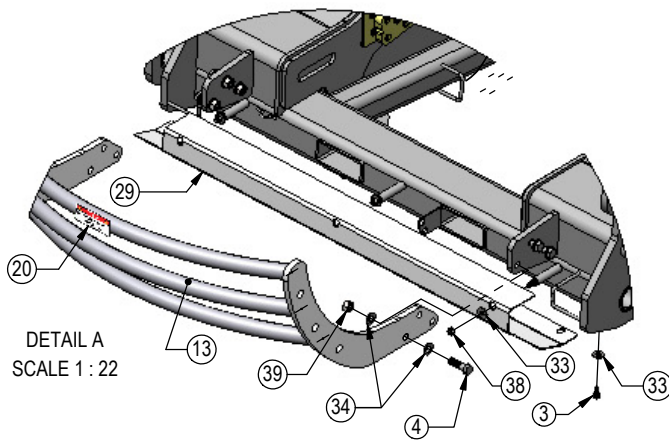

Note: Install all bolts before tightening.

ITEM NO.	QTY.	PART NO.	DESCRIPTION
1	4	16-18879	12mm x 1.75mm x 35mm Serrated Flange Bolt 10.9 CZ
2	8	16-20032	5/16" x 3/4" Hex Bolt Gr 5 NC
3	4	16-20124	1/2" x 1" Hex Bolt Gr.5 NC
4	6	16-20220	3/4" x 2-1/2" Hex Bolt Gr 5 NC
5	2	16-20357	3/8" x 1-3/4" Hex Bolt Gr 8 NC
6	32	16-20509	3/4" x 2-1/4" Hex Bolt Gr.8 NC
7	10	16-20512	3/4" x 3" Hex Bolt Gr 8 NC
8	14	16-20514	3/4" x 3-1/2" Hex Bolt Gr 8 NC
9	4	16-20542	7/8" x 3" Hex Bolt Gr 8 NC
10	8	16-20558	1" x 2" Hex Bolt Gr. 8 NC
11	10	16-2486	24mm x 3.0mm x 100mm Hex Bolt
12	16	16-2487	20mm x 2.5mm x 60mm Hex Bolt Gr. 10.9
13	1	18-18059R2	Grill Guard Weld
14	1	18-18415R1	Bracket
15	4	18-19100	9RX Final Drive Bracket
16	2	18-19104	Rear Bracket Weld

ITEM NO.	QTY.	PART NO.	DESCRIPTION
17	1	18-19108-L	Front Bracket, Left
18	1	18-19108-R	Front Bracket, Right
19	2	27-18880	Ag Pro Plus Decal
20	1	27-18882	Not For Pushing or Pulling Decal
21	1	27-18887	Grouser Name Plate Decal
22	1	27-9506	Serial Tag Decal
23	3	44-18141	Shim, Front 1/8"
24	3	44-18142	Shim, Rear 1/8"
25	3	44-18143	Shim, Front 1/16"
26	3	44-18144	Shim, Rear 1/16"
27	2	44-18147R1	Plate, Front Nut
28	2	44-18245	Rear Nut Plate Weldment
29	1	44-19486	Plate, Cover
30	1	54-19630	Undercarriage Weld
31	104	57-19088	3/4" Hardened HD Flat Washer YZ
32	2	57-20742	3/8" Flat Washer
33	7	57-20744	1/2" Flat Washer
34	12	57-20757	3/4" Flat Washer - 1-1/2" OD
35	18	57-20758	7/8" SAE Hardened Flat Washer - 1-3/4" OD
36	32	70-20597	3/4" Hex Nut Gr.8 NC
37	4	70-20598	7/8" Hex Nut Gr 8 NC
38	3	70-20604	1/2" Center Lock Hex Nut
39	6	70-20607	3/4" Center Lock Hex Nut NC
40	2	70-20622	3/8" Flange Hex Nut Gr 5 NC
41	8	70-20627	3/4" Flange Hex Nut

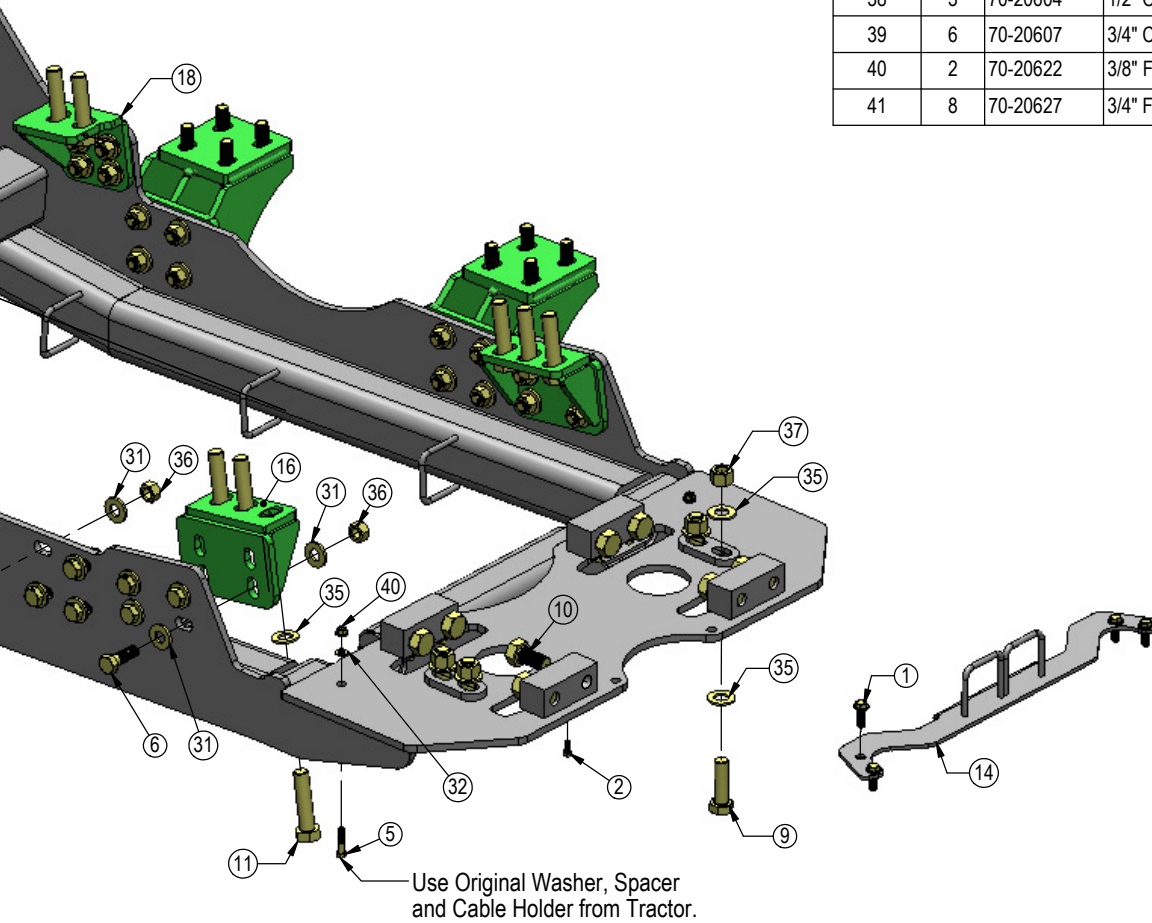

DWG. NO.: 19630-A

Improvements

Grouser Products Inc. is continually striving to improve its products. We reserve the right to change prices, specification, or equipment at any time without notice. We also reserve the right to make improvements or changes when it becomes practical and possible to do so without incurring any obligation to make changes or additions to the equipment sold previously.

Warranty

Grouser Products warrants to the original purchaser of each item that the product be free from defects in material and workmanship under normal use and service for a period of **two (2) years for Agriculture Series Blades and one (1) year for Heavy Duty Series from date of original retail delivery.**

The obligation of the consumer under this warranty:

1. To read the operators manual and to operate, lubricate, maintain and store equipment in accordance with the instructions listed in the operators manual.
2. To inspect equipment and if any part needs repair or replacement when continued use would cause damage or wear to other parts or safety.
3. All equipment or parts claimed to be defective in material or workmanship must be made available for inspection at the place of business of a dealer authorized to handle the equipment covered by this warranty, or, upon request by Grouser Products, shipped to the Grouser Products factory in West Fargo, North Dakota.

The obligation of the dealer under this warranty:

1. Complete warranty registration form and submit within 30 days of sale.
2. Contact Grouser Products for authorization prior to performing any warranty repairs or part replacement.
3. Complete warranty request form and submit with photos and supporting documentation.

The obligation of Grouser Products under this warranty:

1. Repair or replace, any equipment or parts, in the judgment of Grouser Products to be defective in material or workmanship.
2. Grouser Products will cover the cost of parts and ground shipping at dealer invoice only.
3. Grouser Products shall have no obligation to bear the cost of labor or transportation in connection with replacement or repair of any such defective parts.

This warranty does not cover:

1. Depreciation or damage caused by normal wear, accident, improper assembly, improper adjustments.
2. Improper maintenance including lack of proper lubrication, or improper use. Including loose bolts, nuts, or fitting due to over tightening or vibration after 20 hours of operation.
3. Repairs or alterations without authorization from a Grouser Products representative.
4. Grouser Products shall have no liability if the equipment has been altered or reworked without the written authorization of Grouser Products.

Grouser Products' parts, which are furnished under this warranty and properly installed, shall be warranted to the same extent as the original parts under this warranty if, and only if, such parts are found to be defective within the original warranty period covering the original equipment.

NO EMPLOYEE OR REPRESENTATIVE OF GROUSER PRODUCTS IS AUTHORIZED TO CHANGE THE WARRANTY IN ANY WAY OR GRANT ANY OTHER WARRANTY.

Contact Us

As always, if you have any questions about your system or other products made by Grouser, feel free to contact us.



755 2nd Ave NW - West Fargo, ND 58078
+1 701-282-7710 | info@grouser.com
www.grouser.com