



Case STX Quad Track with Cast Yoke

Undercarriage Installation Instructions

Caution:

- Always use precaution when working around any equipment.
- Always wear safety glasses.
- Follow tractor manufacturer's safety guidelines when installing this product.
 1. Read all instructions prior to installation.
 2. Remove existing toolboxes and tow cable holder if equipped.
 3. Remove the 2 -24mm bolts and spacers from the front axle on the left and right side of the tractor. Discard the spacers.
 4. Install the yoke brackets (PN: 18-11540) (see pg. 2 for correct orientation). Dip the previously removed 24mm bolts in W30 oil and install with a heavy flat washer (PN: 57-20819) on each bolt and tighten finger tight.
 5. Install 2 studs (PN: 16-3204) in the front 2 holes on tractor (see pg. 2). Leave 2.25" of stud sticking out of tractor prior to mounting. Install 20mm nut (PN: 70-3494) from top of stud to prevent it from turning further into the tractor frame when final torque is applied.
 6. Position the undercarriage (U/C) under tractor, center on the frame of the tractor. Lift U/C to within 3/4" of touching the tractor frame. Start 6 - 20mm bolts (PN: 16-1510) with 1 heavy washer (PN: 57-8836) on each bolt, into slots at front of U/C, turn in until washers contact U/C.
 7. Install a heavy washer (PN: 57-8836) and 20mm nut on each stud, tighten until washers contact U/C.
 8. Raise rear of U/C up until the two-rear mounting ears touch up against the cross member of the tractor.
Be sure that the vertical push plates are firmly against the cross member.
 9. Using the two holes in the ears as guides, drill 2 - 1" holes through the cross member and install 2 - 1" x 3" bolts (PN: 16-20562) with 1" nuts (PN: 70-20599). Tighten finger tight.
 10. Insert 4 - 3/4" bolts (PN: 16-20220) into each yoke bracket from the top with a nut (PN: 70-20607) on the bottom.
 11. Once all bolts have been started, torque the two rear ear 1" bolts to 903 ft·lbs.
 12. Torque the 8 - 3/4" yoke bracket bolts to 257 ft·lbs. and the 4 - 24mm bolts to 555 ft·lbs.
 13. Torque the 8 - 20mm front vertical bolts to 432 ft·lbs.
 14. Using the side frame holes as guides, drill 6 - 1" holes through side of tractor frame.
Caution: When drilling, be aware of all parts behind the material being drilled so that you do not mistakenly hit or puncture components on engine side of tractor frame.
 15. Install 4 - 1" x 2-1/2" bolts (PN: 16-20560) with 1.00" ID washers (PN: 57-3682) and 1" nuts (PN: 70-20599) in the top four holes. Install 2 - 1" x 3" bolts (PN: 16-20562) with 1.00" ID washers and 1" nuts in the bottom two holes. Torque 1" bolts to 903 ft·lbs. See attached diagram for clarification.
 16. After first 8 hours of use, re-torque all bolts.
 17. Check all fasteners regularly to ensure proper operation of equipment.

THE INFORMATION CONTAINED IN THIS DRAWING IS THE SOLE PROPERTY OF GROUSER PRODUCTS INC ANY REPRODUCTION IN PART OR WHOLE WITHOUT THE WRITTEN PERMISSION OF GROUSER PRODUCTS INC IS PROHIBITED.

Assembly to be used on all Quads with S/N STX JEE0106701 or later
 Parts only shown on left side. Right side is identical.

| ITEM NO. | QTY. | PART NO. | DESCRIPTION |
|----------|------|------------|--|
| 1 | 6 | 16-1510 | 20 mm x 2.5mm x 90 mm Metric Hex Bolt Gr 10.9 |
| 2 | 8 | 16-20220 | 3/4" x 2-1/2" Hex Bolt Gr 5 NC |
| 3 | 4 | 16-20560 | 1" x 2-1/2" Hex Bolt Gr 8 NC |
| 4 | 4 | 16-20562 | 1" x 3" Hex Bolt Gr 8 NC |
| 5 | 2 | 16-3204 | 20mm x 2.5mm x 115mm 8.8 Stud (STX UC) |
| 6 | 1 | 18-11540-L | STX Quad Cast Yoke Bracket - Left |
| 7 | 1 | 18-11540-R | STX Quad Cast Yoke Bracket - Right |
| 8 | 1 | 54-13200 | PL-41 UC Case STX Quad 375-500 Cast Yoke |
| 9 | 4 | 57-20819 | 1" Flat Washer Heavy Duty Gr 8 |
| 10 | 6 | 57-3682 | 1.00" ID x 2-1/2" OD x 0.375" Heavy Washer CZ Plated |
| 11 | 8 | 57-8836 | 2.50 O.D. x .91 I.D. x .50 Thick CZ Plating |
| 12 | 8 | 70-20599 | 1" Hex Nut Gr 8 NC |
| 13 | 8 | 70-20607 | 3/4" Hex Center Lock Nut Gr 5 NC |
| 14 | 4 | 70-3494 | 20mm Hex Nut 2.5 Pitch |

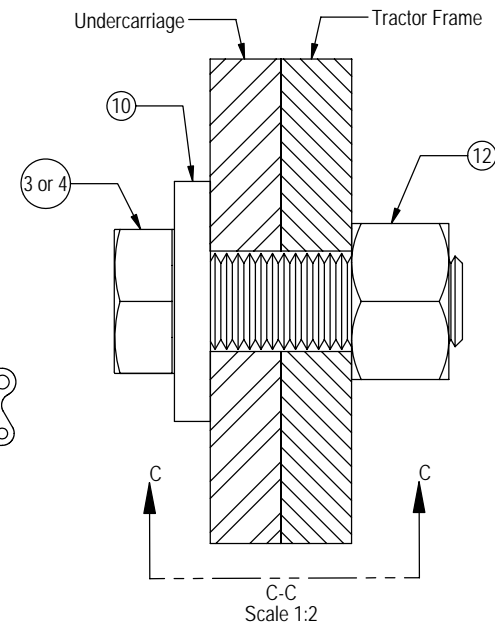

Be sure push plates are firmly against cross member.

Drill cross member and install 2 - 1" x 3" bolts

DETAIL A
 SCALE 1 : 12



Drill tractor frame and install 6 bolts.

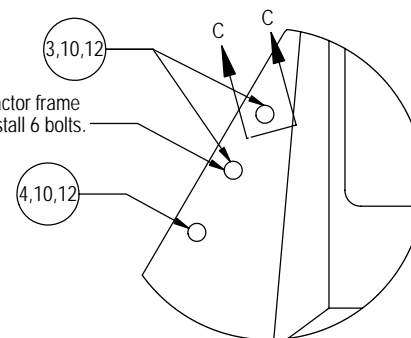

DETAIL B
 SCALE 1 : 12

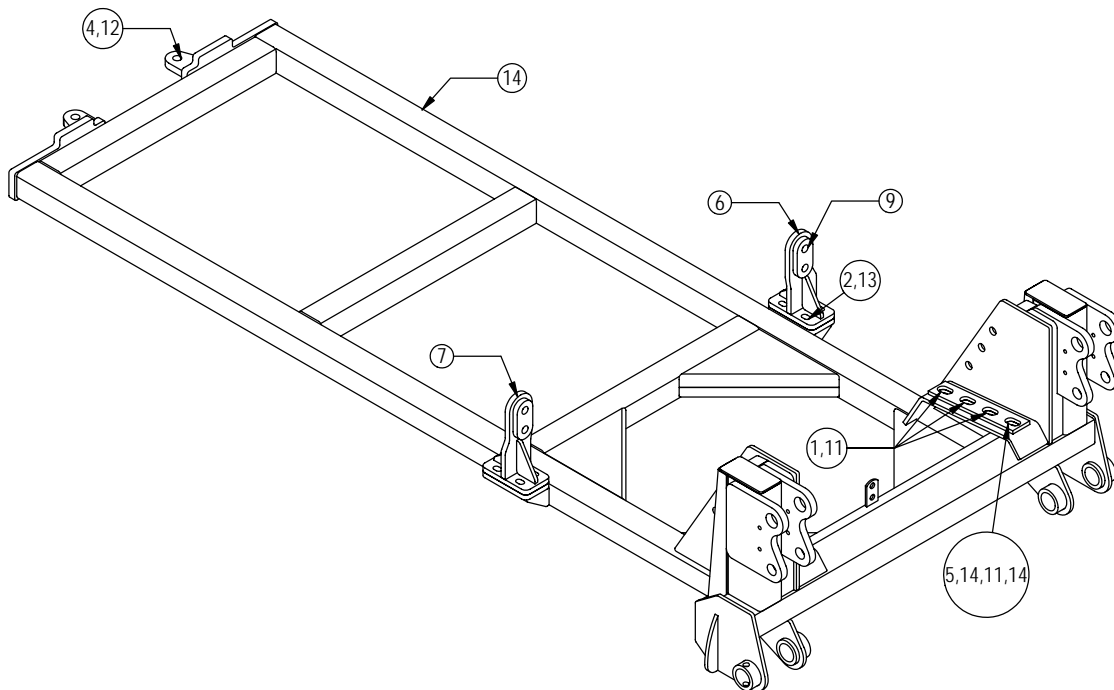

GROUSER PRODUCTS INC.

755 2nd Ave NW Phone 701.282.7710
 West Fargo, ND 58078 Fax 701.282.8131
 WWW.GROUSER.COM

TITLE PL4100 UC STX Quad
 Cast Yoke

DWG. NO.
 13200-A

Date:
 11/8/2005

Scale:
 1:28

Sheet:
 1