



FH-400 Agco DTA/Massey DT8400/ Challenger MT600B Suspended Axle Undercarriage Installation Instructions

Caution:

- Always use precaution when working around any equipment.
- Always wear safety glasses.
- Follow tractor manufacturer's safety guidelines when installing this product.
 1. Read all instructions prior to installation.
 2. Remove weights and mounting bracket from front of tractor. Bolts will be reused for mounting the undercarriage (U/C).
 3. Position the U/C under the tractor and center with the frame of the tractor.
 4. Lift the U/C until the holes on the U/C line up with the front weight bracket mounting holes.
 5. At the front of the tractor, use the weight mount bracket bolts to attach the U/C to the front of the tractor.
 6. Attach the right rail (PN: 46-11541-R) to the right side of the tractor frame with 2 - 20mm bolts (PN: 16-1876) and 2 - 3/4" flat washers (PN: 57-20747). See attached diagram for clarification.
 7. Attach the left rail (PN: 46-11541-L) to the left side of the tractor frame with 2 - 20mm bolts (PN: 16-1876) and 2 - 3/4" flat washers (PN: 57-20747). See attached diagram for clarification.
 8. Attach the right rail to the right side of the undercarriage with 3 - 1" bolts (PN: 16-20558), 6 - 1" heavy duty flat washers (PN: 57-20819), and 3 - 1" nuts (PN: 70-20599). See attached diagram for clarification.
 9. Attach the left rail to the left side of the undercarriage with 3 - 1" bolts (PN: 16-20558), 6 - 1" heavy duty flat washers (PN: 57-20819), and 3 - 1" nuts (PN: 70-20599). See attached diagram for clarification.
 10. Once all bolts are installed, torque the front bolts to 432 ft-lbs., all 20mm bolts to 432 ft-lbs., and all 1" bolts to 903 ft-lbs.
 11. Remove the front 4 bolts from the tractors drawbar fulcrum.

Note: For Serial or Engine Number up to R151071 go to Step #12 and for Serial or Engine Number after R151072 go to Step #13.
 12. Attach the new drawbar bracket (PN: 18-14320) to the tractor drawbar fulcrum with 4 - 20mm x 180mm bolts (PN: 16-20250180) and a 3/4" ID x .375" washer (PN: 57-3680) on each bolt. See attached diagram for clarification. Proceed with Step #14.
 13. Attach the new drawbar bracket (PN: 18-14320) to the tractor drawbar fulcrum with 4 - 20mm x 180mm bolts (PN: 16-20250180) and a 3/4" flat washer (PN: 57-20747) on each bolt. See attached diagram for clarification. Proceed with Step #14.
 14. Push the drawbar bracket back until the push blocks are tight up against the tractor drawbar fulcrum. Torque the 20mm bolts to 432 ft-lbs.

- 15.** Install 2 - 1" x 3" bolts (PN: 16-20562) and 2 - 1" nuts (PN: 70-20599) on the front end of the push pole (PN: 17-14315). See attached diagram for clarification.
- 16.** Insert the front ear bracket (PN: 18-14325) into the push pole.
- 17.** Position the push pole under the tractor. See the attached diagram for the correct orientation.
- 18.** Attach the rear of the push pole to the drawbar bracket with a 1" pin (PN: 43-3472), 1" flat washer (PN: 57-20749), and a pin clip (PN: 43-7767).
- 19.** Attach the front of the push pole to the undercarriage with a 1" pin (PN: 43-3472) and a pin clip (PN: 43-7767).
- 20.** Unscrew the two 1" x 3" bolts at the front of the push pole until they are tight against the plate on the front ear bracket. Torque the 1" bolts to 90-95 ft-lbs.
- 21.** Tighten the nuts up tight against the push pole. Use the nuts to lock the bolts in place.
- 22.** After first 8 hours of use, re-torque all bolts.
- 23.** Check all fasteners regularly to ensure proper operation of equipment.

THE INFORMATION CONTAINED IN THIS DRAWING IS THE SOLE PROPERTY OF GROUSER PRODUCTS INC ANY REPRODUCTION IN PART OR WHOLE WITHOUT THE WRITTEN PERMISSION OF GROUSER PRODUCTS INC IS PROHIBITED.

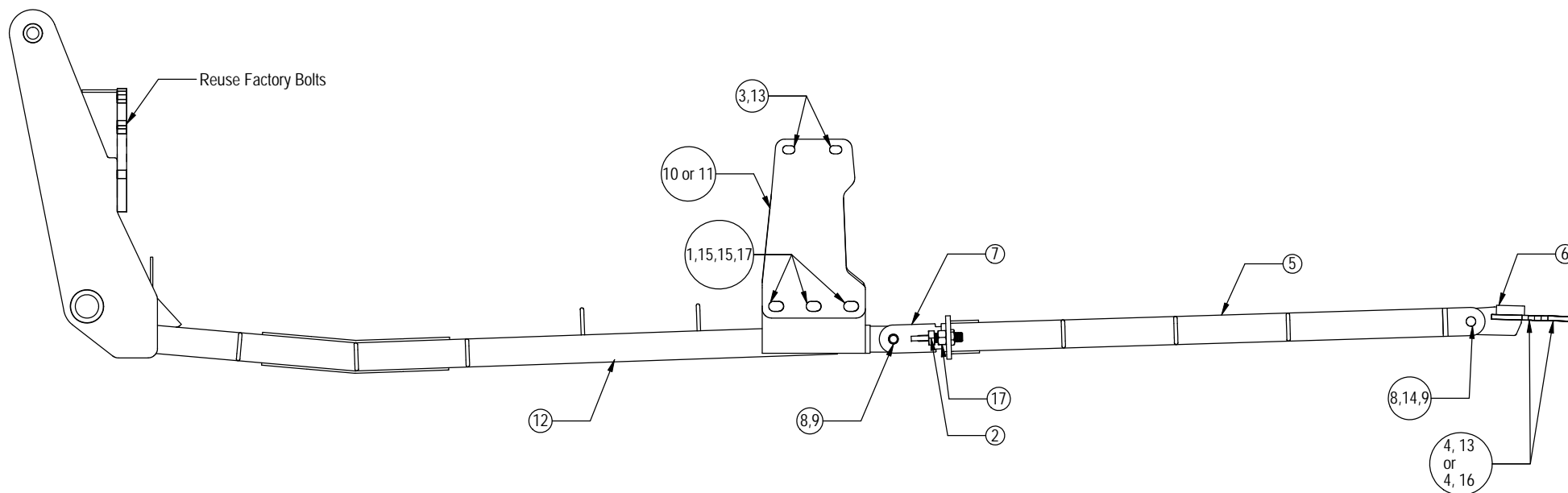

Item No.	Qty.	Part No.	Description
1	6	16-20558	1" x 2" Hex Bolt Gr 8 NC
2	2	16-20562	1" x 3" Hex Bolt Gr 8 NC
3	4	16-1876	20mm x 2.5mm x 70mm Metric Hex Bolt Gr. 10.9
4	4	16-20250180	20mm x 2.5mm x 180mm Metric Hex Bolt Gr. 10.9
5	1	17-14315	Agco DTa/Massey 8400/Challenger MT600B Push Pole
6	1	18-14320	Agco DTa/Massey 8400/Challenger MT600B Drawbar Bracket
7	1	18-14325	Agco DTa/Massey 8400/Challenger MT600B Front Ear Bracket
8	2	43-3472	1" x 3.12" Welded Pin w/ Holes and Washer
9	2	43-7767	Cylinder Hitch Pin Clip
10	1	46-11541-L	FH-400 Massey 8400, Cat 600B Series Side Rail - Left
11	1	46-11541-R	FH-400 Massey 8400, Cat 600B Series Side Rail - Right
12	1	54-13840	FH-400 UC Agco/Massey DT8400 Suspended Axle
13	8	57-20747	3/4" Flat Washer
14	1	57-20749	1" Flat Washer
15	12	57-20819	1" Flat Washer Heavy Duty Gr 8 (USS)
16	4	57-3680	2.00" OD x .75" ID x .375" Washer
17	8	70-20599	1" Hex Nut Gr 8 NC

Parts only shown on left side. Right side is identical.



GROUSER PRODUCTS INC.

755 2nd Ave NW Phone 701.282.7710
 West Fargo, ND 58078 Fax 701.282.8131
 WWW.GROUSER.COM

TITLE: FH-400 UC Agco Dta/Massey 8400/
 Challenger MT600B Suspended Axle

Date: 11/10/2010 DWG. NO.: 13840-A