



Fendt 900 Series 1

Undercarriage Installation Instructions

Caution:

- Always use precaution when working around any equipment.
- Always wear safety glasses.
- Follow tractor manufacturer's safety guidelines when installing this product.
 1. Read all instructions prior to installation.
 2. Position the undercarriage (U/C) under the tractor with the front ears towards the front of the tractor and center with the frame of the tractor.
 3. Support the front linkage frame and remove the pins that hold the frame to the tractor.
 4. Lift the front of the Fendt support frame.
 5. Once the ears are aligned with the ears on the tractor frame and the front linkage frame, insert the pint (PN: 43-3917).
 6. Once the pin is in place, insert a spacer (PN: 44-8490) in the open space between the legs of the pin heads. Insert a 1/2" bolt (PN: 16-20126) with a 1/2" fender washer (PN: 57-20794) through each spacer and the hole on the Fendt support frame. See attached diagram for any clarification.
 7. Remove the rear bolts from the tractor frame where the rear of the Fendt support frame will be installed.
 8. Lift the rear of the Fendt support frame.
 9. Make sure the holes will line up. If the holes line up, continue with Step #15 otherwise continue with next step.
 10. If the holes don't line up with the tractor frame, measure how far they are off.
 11. Drop the Fendt support frame to move the rear plate into the correct position.
 12. Break off the tack welds on the plate and move the plate the distance that the holes were off by.
 13. Use a few tack welds to attach the plate to the tubes again to do a check fit before fully welding the plate.
 14. Lift the rear of the Fendt support frame back in place and check to make sure the holes line up.
 15. Drop the Fendt support frame, grind away any paint around the tubes and plate where you will need to weld, and then fully weld the plate to the tubes with a 1/2" weld all around.
 16. Paint the non-painted parts with a good quality enamel spray paint.
 17. Lift the rear of the Fendt support frame and attach to the tractor frame with the original tractor hardware that was removed in Step #7 .
 18. Torque the rear bolts to tractor manufacturer's specification.
 19. After the first 8 hours of use, re-torque all bolts.
 20. Check all fasteners regularly to ensure proper operation of equipment.

THE INFORMATION CONTAINED IN THIS DRAWING IS THE SOLE PROPERTY OF GROUSER PRODUCTS INC ANY REPRODUCTION IN PART OR WHOLE WITHOUT THE WRITTEN PERMISSION OF GROUSER PRODUCTS INC IS PROHIBITED.

ITEM NO.	PART NO.	QTY.	DESCRIPTION
1	17-3914R1	1	Push Pole
2	43-3917	1	Pin Weld
3	44-8490	1	Spacer
4	57-20794	1	1/2" Fender Washer
5	16-20126	1	1/2" X 1-1/2" Gr. 5 NC Hex Bolt

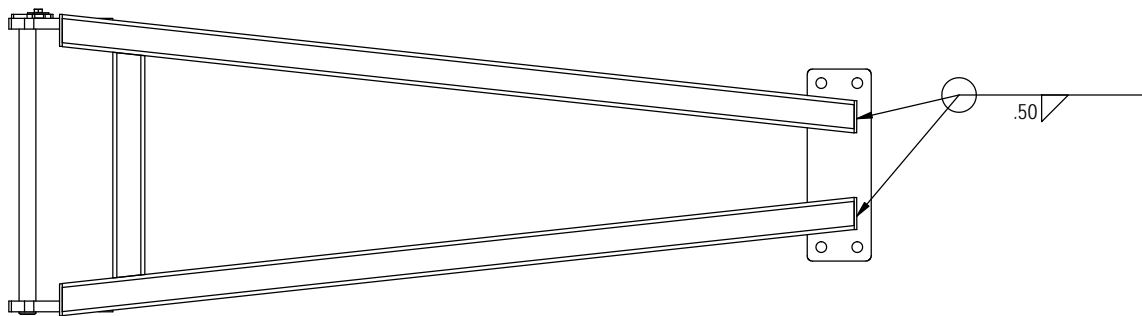
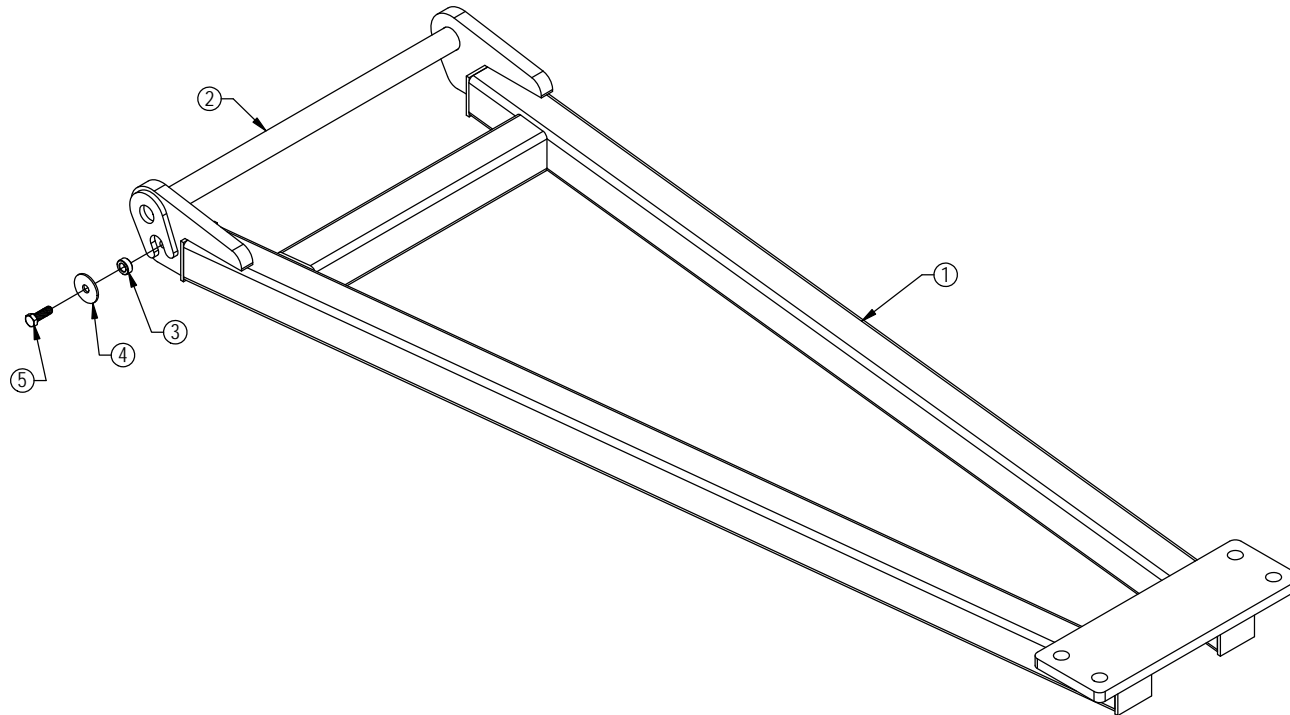

GROUSER PRODUCTS INC.

755 2nd Ave NW Phone 701.282.7710
 West Fargo, ND 58078 Fax 701.282.8131
 WWW.GROUSER.COM

TITLE: Fendt 900 (Series 1)

Date: 5/29/2015

DWG. NO.: 2468



Torque Arm - Front Hitch

Installation Instructions

Caution:

- Always use precaution when working around any equipment.
- Always wear safety glasses.
- Follow tractor manufacturer's safety guidelines when installing this product.
- Read all instructions prior to installation.
 1. Position the torque arm between the front hitch arms. The longest edge of the plate should be closest to the tractor and the angled edge on the bottom. See the photo below for correct orientation.
 2. Support the torque arm and install a bolting plate with 4 - 3/4" x 3-3/4" bolts and 4 - 3/4" nuts on each side.
 3. Once the bolts are all installed, push the torque arm evenly towards the tractor. Keep the torque arm parallel to the front of the tractor.
 4. Torque the 3/4" bolts to 100 ft-lbs.
 5. After first 8 hours of use, re-torque all bolts.
 6. Check all fasteners regularly to ensure proper operation of equipment.

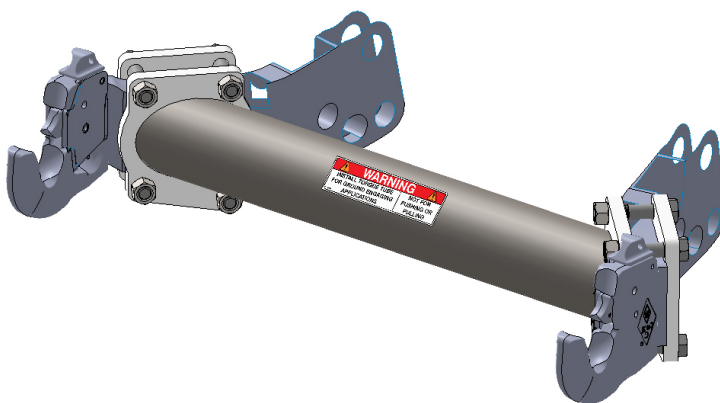

Note: The style of front hitch arms may vary slightly.



THE INFORMATION CONTAINED IN THIS DRAWING IS THE SOLE PROPERTY OF GROUSER PRODUCTS INC ANY REPRODUCTION IN PART OR WHOLE WITHOUT THE WRITTEN PERMISSION OF GROUSER PRODUCTS INC IS PROHIBITED.

ITEM NO.	QTY.	PART NO.	DESCRIPTION
1	1	11-19704R1	Torque Arm
2	8	16-20225	3/4" x 3-3/4" Gr.5 Hex Bolt
3	1	27-40405	Warning Decal - Torque Arm
4	2	44-19701R1	Plate
5	8	70-20607	3/4" Center Lock Hex Nut NC

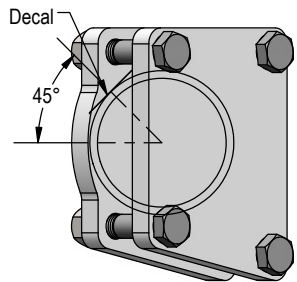
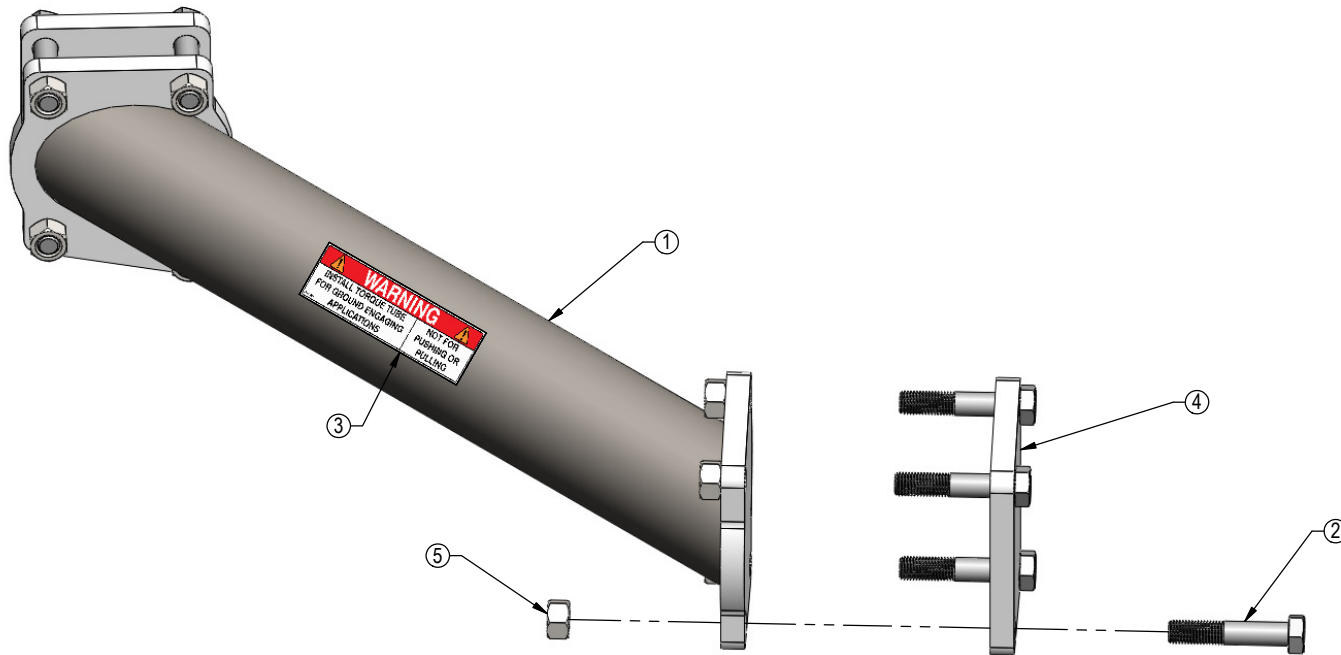

Placement of Warning Decal



GROUSER PRODUCTS INC.

755 2nd Ave NW Phone 701.282.7710
West Fargo, ND 58078 Fax 701.282.8131
WWW.GROUSER.COM

TITLE: Torque Arm for Front Hitches

Date: 3-1-2017

DWG. NO.: 19704-A