



# Fendt 800 Tier 4

## Undercarriage Installation Instructions

### **Caution:**

- Always use precaution when working around any equipment.
  - Always wear safety glasses.
  - Follow tractor manufacturer's safety guidelines when installing this product.
1. Read all instructions prior to installation.
  2. Install th 2 - 1" x 6" bolts and 2 - 1" nuts at the rear of the support frame. See attached diagram for clarification. Tighten bolts only until the end of the bolt is flush with the welded nut on the support frame.
  3. Attach the push plate to the rear of the support frame with 4 - 3/4" flat washers and 4 - 3/4" nuts. The round edge of the push plate should be towards the open back of the support frame. Push the push plate towards the front of the front support up against the 1" bolts installed in the previous step. ONLY finger tighten the nuts for now. See attached diagram for clarification on orientation of the push plate.
  4. Position the support frame under the tractor with the front ears towards the front of the tractor and center with the frame of the tractor.
  5. Insert the 2 - spacers on top of the rear push plate and in the slots at the rear of the support frame.
  6. Lift the rear of the support frame.
  7. Insert 2 - 20mm x 110mm bolts with 2 - 3/4" washers through the push plate, the spacers that were installed in Step #5, and into the threaded holes right in front of the drawbar bracket.
  8. Support the front linkage frame and remove the pins that hold the frame to the tractor.
  9. Lift the front of the support frame.
  10. Once the ears are aligned with the ears on the tractor frame and the front linkage frame, insert a new pin on each side.
  11. Once the pins are in place, insert a spacer in the open space between the legs of the pin heads. Insert a 3/4" bolt with a 3/4" flat washer through each spacer and the hole on the U/C. See attached diagram for any clarification.
  12. After the bolts are in, install a 3/4" nut on each bolt.
  13. Torque the front 3/4" bolts to 257 ft-lbs.
  14. Tighten the 1" bolts to push the push plate up tight against the tractor casting. Torque the 1" bolts to 90-95 ft-lbs.
  15. Tighten the nuts up against the front support. Use the nuts to lock the bolts in place
  16. Tighten the 3/4" nuts up tight against the rear plate on the support frame. Use the nuts to lock the push plate in place.
  17. Torque the 3/4" nuts to 257 ft-lbs.
  18. Torque the vertical 20mm bolts to 432 ft-lbs.
  19. Verify that the tires will not hit the support frame when fully turned and that the axle will not hit the support frame when fully suspended.
  20. After the first 8 hours of use, re-torque all bolts.
  21. Check all fasteners regularly to ensure proper operation of equipment.

THE INFORMATION CONTAINED IN THIS DRAWING IS THE SOLE PROPERTY OF GROUSER PRODUCTS INC. ANY REPRODUCTION IN PART OR WHOLE WITHOUT THE WRITTEN PERMISSION OF GROUSER PRODUCTS INC. IS PROHIBITED.

ITEM NO.	QTY.	PART NO.	DESCRIPTION
1	2	16-20220	3/4" x 2-1/2" Hex Bolt Gr 5 NC
2	2	16-17271	1" X 6" Hex Bolt Gr 8 NC (Full Thread)
3	2	16-3712	20mm x 2.5mm x 110mm Gr. 10.9 Hex Bolt
4	2	19-13515	Spacer, NR Pin
5	2	43-16813	Pin Weld
6	1	44-40395	Plate, Push
7	2	53-40394	Spacer
8	1	54-40390	Undercarriage
9	8	57-20747	3/4" Flat Washer
10	2	70-20589	1" Hex Nut Gr 5 NC
11	6	70-20607	3/4" Center Lock Hex Nut NC

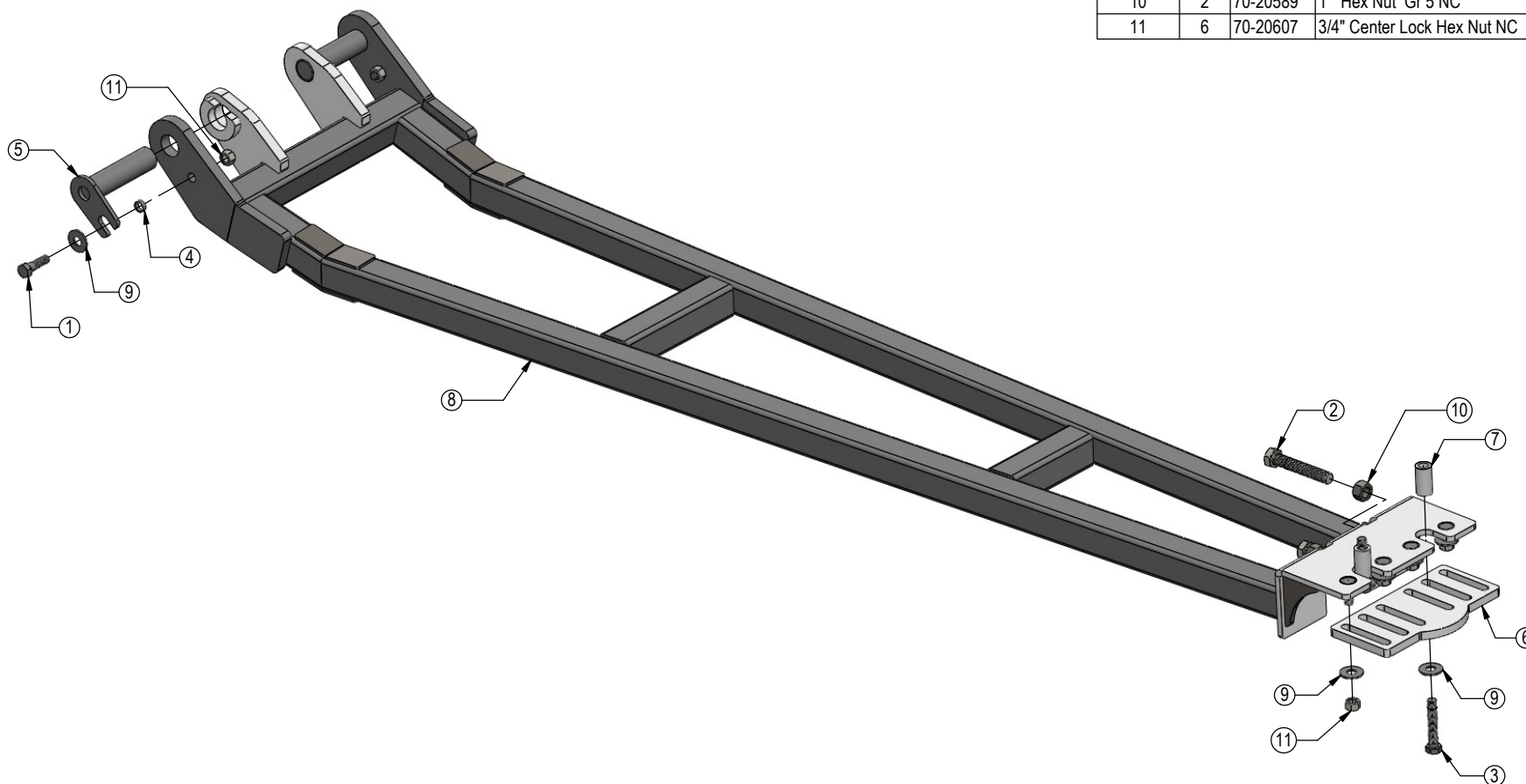

**GROUSER PRODUCTS INC.**

755 2nd Ave NW Phone 701.282.7710  
West Fargo, ND 58078 Fax 701.282.8131  
WWW.GROUSER.COM

TITLE: Fendt 800 Front Support

Date: 5/2/2017

DWG. NO.: 40390-A



# Torque Arm - Front Hitch

## Installation Instructions

### Caution:

- Always use precaution when working around any equipment.
  - Always wear safety glasses.
  - Follow tractor manufacturer's safety guidelines when installing this product.
  - Read all instructions prior to installation.
1. Position the torque arm between the front hitch arms. The longest edge of the plate should be closest to the tractor and the angled edge on the bottom. See the photo below for correct orientation.
  2. Support the torque arm and install a bolting plate with 4 - 3/4" x 3-3/4" bolts and 4 - 3/4" nuts on each side.
  3. Once the bolts are all installed, push the torque arm evenly towards the tractor. Keep the torque arm parallel to the front of the tractor.
  4. Torque the 3/4" bolts to 100 ft-lbs.
  5. After first 8 hours of use, re-torque all bolts.
  6. Check all fasteners regularly to ensure proper operation of equipment.

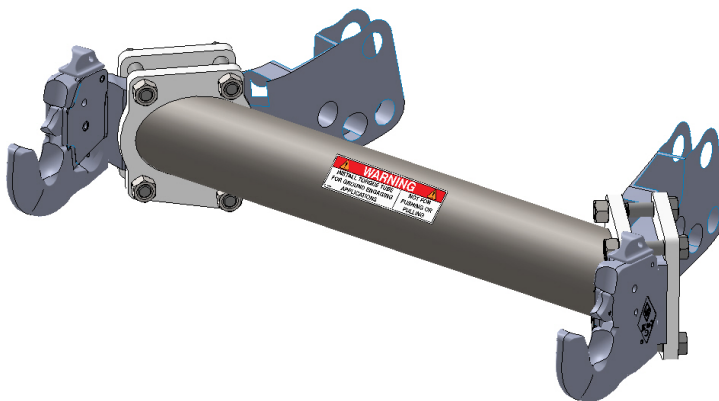

**Note:** The style of front hitch arms may vary slightly.



THE INFORMATION CONTAINED IN THIS DRAWING IS THE SOLE PROPERTY OF GROUSER PRODUCTS INC. ANY REPRODUCTION IN PART OR WHOLE WITHOUT THE WRITTEN PERMISSION OF GROUSER PRODUCTS INC. IS PROHIBITED.

ITEM NO.	QTY.	PART NO.	DESCRIPTION
1	1	11-19704R1	Torque Arm
2	8	16-20225	3/4" x 3-3/4" Gr.5 Hex Bolt
3	1	27-40405	Warning Decal - Torque Arm
4	2	44-19701R1	Plate
5	8	70-20607	3/4" Center Lock Hex Nut NC

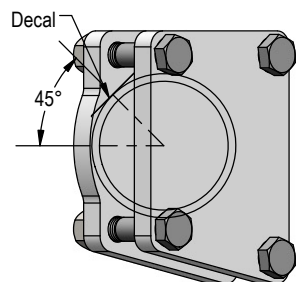
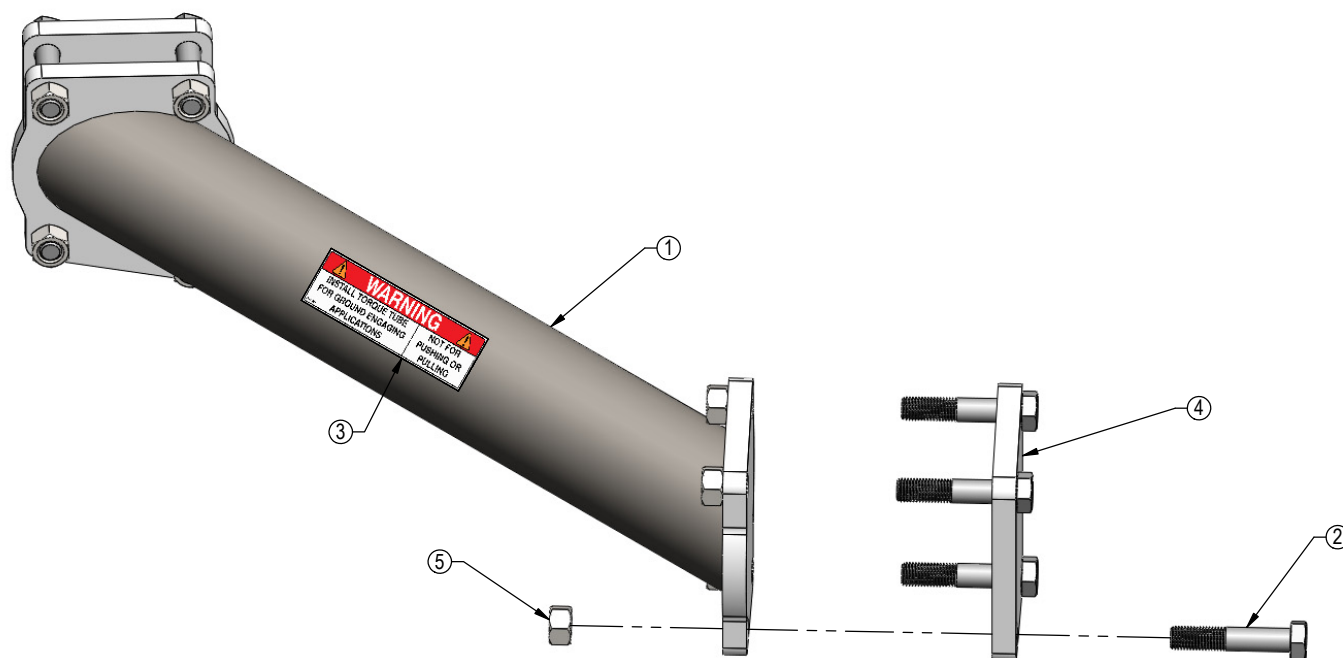

Placement of Warning Decal



**GROUSER PRODUCTS INC.**

755 2nd Ave NW Phone 701.282.7710  
West Fargo, ND 58078 Fax 701.282.8131  
WWW.GROUSER.COM

TITLE: Torque Arm for Front Hitches

Date: 3-1-2017

DWG. NO.: 19704-A