

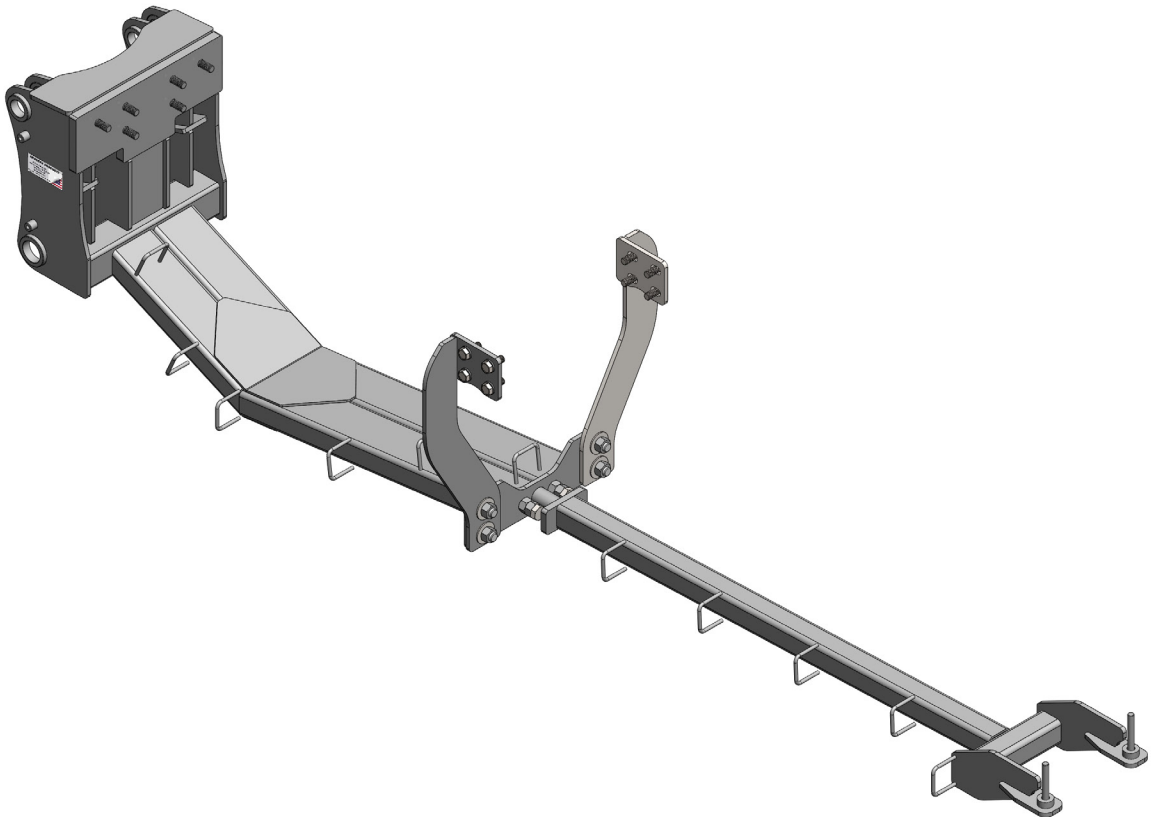

Case Puma & New Holland T7 - T4B Undercarriage Installation Instructions



For Models:

Case Puma: 150, 165

New Holland: T7.175, T7.190, T7.210

| |
|---------------|
| Purchase Date |
| Serial Number |
| Model Number |
| Tractor Model |
| Dealer |

To The Owner

This manual contains information concerning the installation of the undercarriage. You have purchased dependable, long lasting equipment, but only by proper care and operation can you expect to receive the performance and long service built into our products. Please read this manual carefully and keep the manual available for ready reference. If you have any questions or concerns, contact Grouser Products.

Caution:

- Always use caution when working around any equipment.
- Always wear safety glasses.
- Follow tractor manufacturer's safety guidelines when installing this product.
- Use paint where necessary to prevent rust.
- Do not modify or permit anyone else to modify or alter the equipment and its components without first consulting Grouser Products.

Note:

- Read all instructions prior to performing installation.
- When installing hardware, only finger tighten until all hardware is in place.
- A full diagram of the assembly with the full list of parts is on pages 4-5.
- Unstrap and remove any components that are attached for shipping.

Pre-Installation

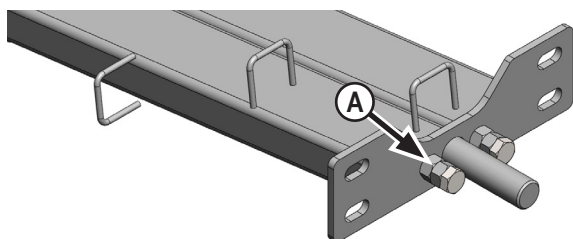

1. Remove the weights and weight carrier from the front of the tractor if necessary.
2. Install 2 - 1" x 6" bolts and 2 - 1" nuts at the rear of the undercarriage (A). Turn the bolts all the way in for installation. The bolts will be adjusted in Step #14.

Undercarriage Installation

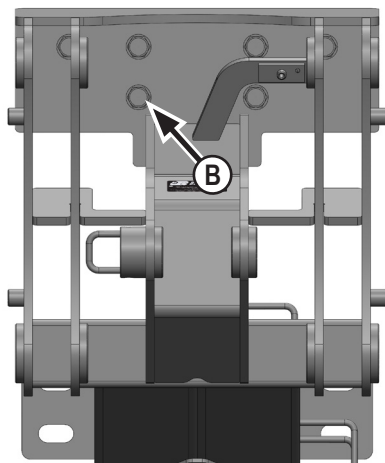

3. Position and center the undercarriage under the tractor.

NOTE: When lifting the undercarriage, watch for any potential pinching of hoses or any other components to prevent any damage.

4. Raise the undercarriage until the front holes of the undercarriage line up with the tractor frame holes.
5. Attach the front of the undercarriage to the front nose casting with 6 - 20mm x 70mm bolts and 6 - 3/4" hardened flat washers (B).

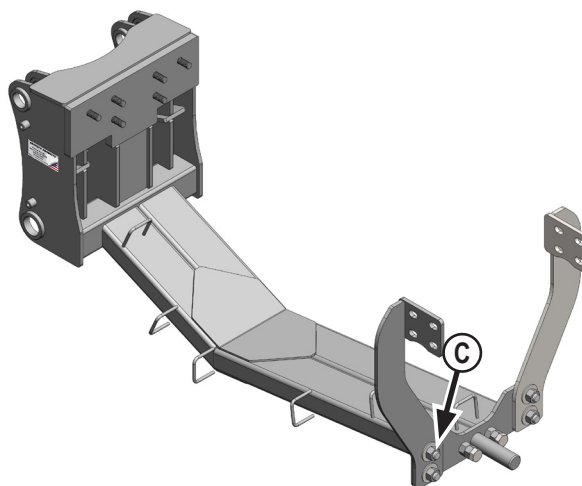

6. Attach the side brackets to the rear of the undercarriage with 4 - 1" x 2-1/2" bolts, 8 - 1" flat washers, and 4 - 1" nuts (C).

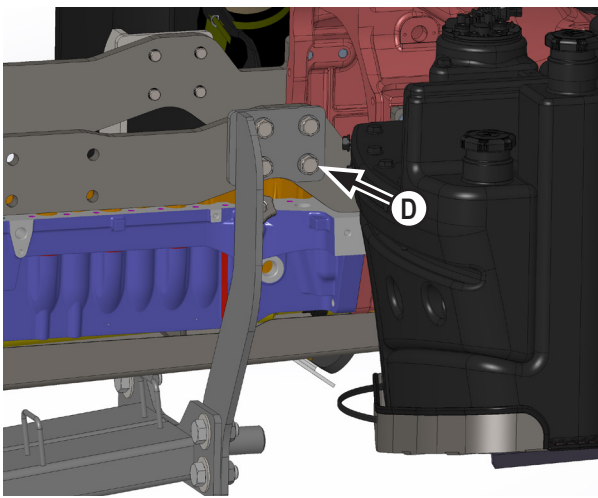

7. Attach the side brackets to the tractor frame with 8 - 20mm x 50mm bolts and 8 - 3/4" flat washers (D).

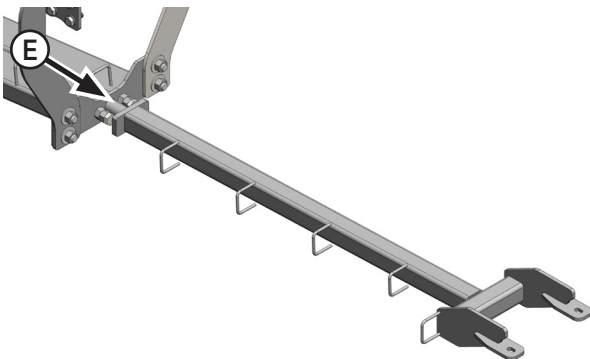

8. Position and center the push pole behind the undercarriage under the rear of the tractor. Lift and slide the front end of the push pole onto the round pin at the rear of the undercarriage (E).

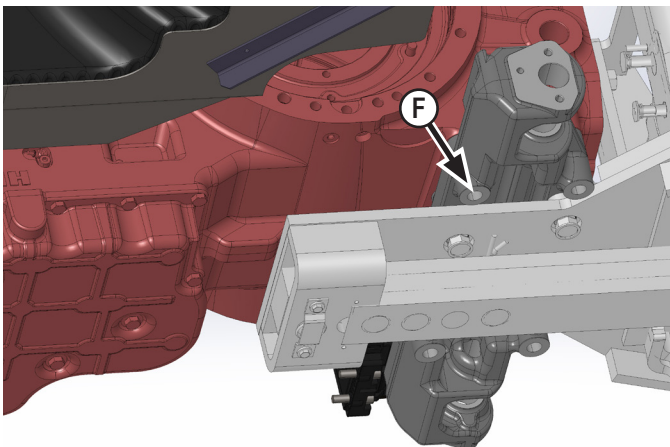

9. Remove the front 2 bolts from the rear 3-point support (F). Keep the hardware in case the undercarriage is removed from the tractor in the future.

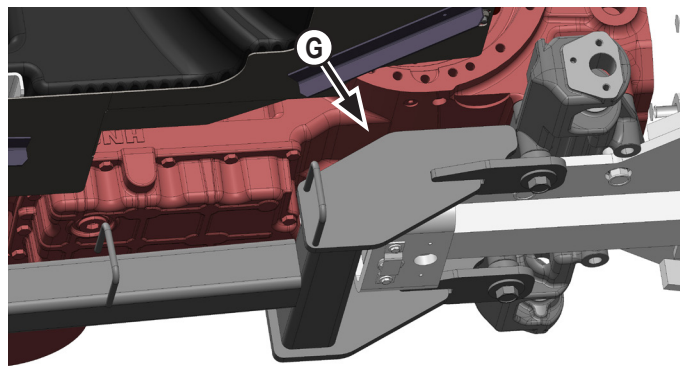

10. Lift the rear of the push pole and attach to the rear 3-point support with 2 - 18mm x 145mm bolts, 2 - 3/4" flat washers, and 2 - spacer plates (G).

NOTE: Some tractors have different drawbars and drawbar supports. If there is a drawbar support attached to the rear 3-point support, the spacer plates in Step #10 are not needed. An example is shown below (H).

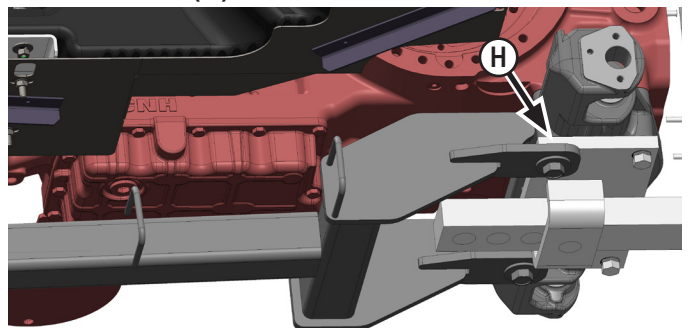

11. Torque the front 20mm bolts (B) to 432 ft-lbs.

12. Torque the 1" bolts (C) to 903 ft-lbs.

13. Torque the side bracket 20mm bolts (D) to 432 ft-lbs.

14. Evenly unscrew the 1" bolts at the rear of the undercarriage until they are tight against the push pole (E). Torque the 1" bolts to 90-95 ft-lbs.

15. Tighten the nuts up tight against the undercarriage. Use the nuts to lock the bolts in place.

16. Torque the rear 18mm bolts (G) for 405 ft-lbs.

17. Route the hoses from the front of the undercarriage through all of the hose loops on the undercarriage and push pole.

18. Route the hoses to the back of the tractor and plug the hoses into the open SCV's at the rear of the tractor.

19. Protect the hoses around sharp corners and moving objects. Use zip ties to hold the hoses in place.

Warning: Fully oscillate the blade angle, tilt, steering, suspension and rear 3-point to check for adequate clearance.

Maintenance

1. After first 8 hours of use, re-torque all bolts. Check to make sure the 1" bolts at the rear of the undercarriage are tight against the push plate as in Step #14.
2. Check all fasteners regularly to ensure proper operation of equipment.
3. Inspect all equipment for existing or potential damages every 10 hours or less.

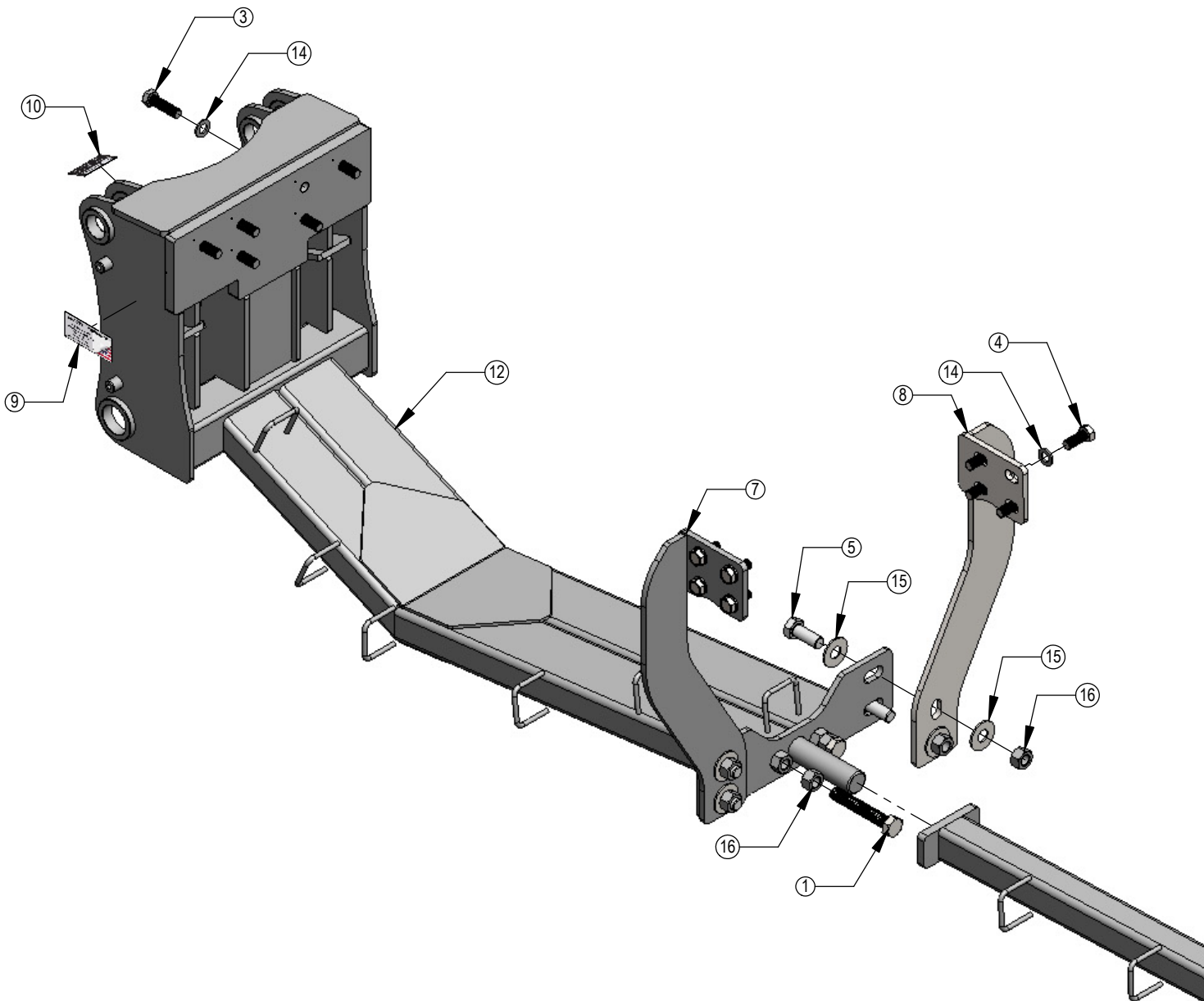

| ITEM NO. | QTY. | PART NO. | DESCRIPTION |
|----------|------|-------------|--|
| 1 | 2 | 16-17271 | 1" X 6" Hex Bolt Gr 8 NC (Full Thread) |
| 2 | 2 | 16-18150140 | 18mm x 1.50mm x 140mm Metric Hex Bolt Gr 10.9 Fine |
| 3 | 6 | 16-1876 | 20mm x 2.5mm x 70mm Gr. 10.9 Hex Bolt |
| 4 | 8 | 16-1878 | 20mm x 2.5mm x 50mm Gr. 10.9 Hex Bolt |
| 5 | 4 | 16-20560 | 1" x 2-1/2" Gr.8 NC Hex Bolt |
| 6 | 1 | 17-41760 | Push Pole Weld |
| 7 | 1 | 18-41770-L | Side Bracket |
| 8 | 1 | 18-41770-R | Side Bracket |
| 9 | 1 | 27-18887 | Grouser Name Plate Decal |
| 10 | 1 | NA | Grouser Dozer Metal Serial Tag |
| 11 | 2 | 44-41766 | Plate, Spacer |
| 12 | 1 | 54-41745 | Puma UC Weld |
| 13 | 2 | 57-20747 | 3/4" Flat Washer |
| 14 | 14 | 57-20757 | 3/4" Flat Washer - 1-1/2" OD |
| 15 | 8 | 57-20819 | 1" Flat Washer Heavy Duty Gr 8 (USS) |
| 16 | 6 | 70-20599 | 1" Hex Nut Gr 8 NC |

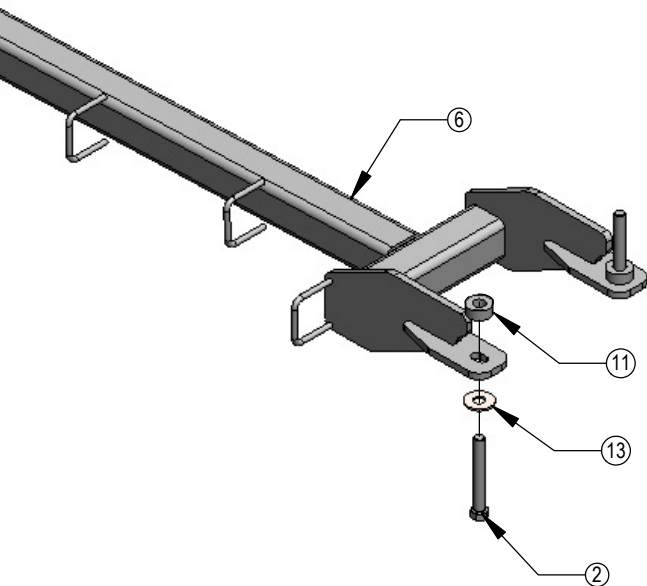

Contact Us

As always, if you have any questions about your undercarriage or other products made by Grouser, feel free to contact us.

Grouser Products

755 2nd Ave NW - West Fargo, ND 58078

Phone: 1-800-747-6182

Fax: 1-701-282-8131

E-mail: grouser@grouser.com

Website: www.grouser.com

Improvements

Grouser Products Inc. is continually striving to improve its products. We reserve the right to change prices, specification, or equipment at any time without notice. We also reserve the right to make improvements or changes when it becomes practical and possible to do so without incurring any obligation to make changes or additions to the equipment sold previously.

Warranty

Grouser Products warrants to the original purchaser of each item that the product be free from defects in material and workmanship under normal use and service for a period of two years from date of original retail delivery. If such equipment is found to be defective within two years, it is the obligation of Grouser Products under this warranty to repair or replace (exclusive of the cost of labor and transportation), any equipment or parts, in the judgment of Grouser Products to be defective in material or workmanship.

All equipment or parts claimed to be defective in material or workmanship must be made available for inspection at the place of business of a dealer authorized to handle the equipment covered by this warranty, or, upon request by Grouser Products, shipped to the Grouser Products factory in West Fargo, North Dakota. Grouser Products shall have no obligation to bear the cost of labor or transportation in connection with replacement or repair of any such defective parts in the setup process.

This warranty covers only defects in material and workmanship. It does not cover depreciation or damage caused by normal wear, accident, improper assembly, improper adjustments, improper maintenance including lack of proper lubrication, or improper use. Therefore, Grouser Products liability under this warranty shall not be effective or actionable unless the equipment is assembled, maintained and operated in accordance with the operating instructions accompanying the equipment. Grouser Products shall have no liability if the equipment has been altered or reworked without the written authorization of Grouser Products.

Grouser Products' parts, which are furnished under this warranty and properly installed, shall be warranted to the same extent as the original parts under this warranty if, and only if, such parts are found to be defective within the original warranty period covering the original equipment.

