



JD 9RX Rear Weight Installation Instructions

Purchase Date
Serial Number
Model Number
Tractor Model
Dealer

To The Owner

This manual contains information concerning the installation of the weight package. You have purchased dependable, long lasting equipment, but only by proper care and operation can you expect to receive the performance and long service built into our products. Please have all operators read this manual carefully and keep the manual available for ready reference. If you have any questions or concerns, contact Grouser Products.

Caution:

- Always use caution when working around any equipment.
- Always wear safety glasses.
- Follow tractor manufacturer's safety guidelines when installing this product.
- Use paint where necessary to prevent rust.
- Do not modify or permit anyone else to modify or alter the equipment and its components without first consulting Grouser Products.

Note:

- When installing hardware, only finger tighten until all hardware is in place.
- A full diagram of the assembly with the full list of parts is on page 3.
- Unstrap and remove any components that are attached for shipping.
- Read all instructions prior to performing installation.

Installation

1. If applicable, remove rear drawbar.
2. Remove rear hardware where weight carrier will be attached..
3. Insert rear weight bracket into the drawbar bracket. Secure with pin, 12mm bolt and 12mm nut.
4. Attach the weight carrier to the rear of the tractor in the existing holes on the tractor frame. Use 4 - 1" x 6" bolts, 4 - 1.05" ID washers, 2 - plate washers, and 4 - 1" nuts to attach back part of the carrier to the tractor frame.
5. Torque the 12mm bolts to 80 ft-lbs.
6. Torque the 1" bolts to 903 ft-lbs.
7. Place all remaining weight plates into the carrier. Plates should be installed so the slots are alternating for use with lifting hooks.
8. Hold plates in place by attaching the weight lock with 4 - 1" x 3-1/4" bolts, 8 - 1" washers, and 4 - 1" nuts to the carrier. Verify the lock is down tight against the weights. Torque the 1" bolts to 903 ft-lbs.

ITEM NO.	Qty.	PART NO.	DESCRIPTION
1	1	16-12175100	12mm x 1.75mm x 100mm Metric Hex Bolt Gr 10.9 Coarse
2	4	16-17271	1" X 6" Hex Bolt Gr 8 NC (Full Thread)
3	4	16-20563	1" x 3-1/4" Hex Bolt Gr 8 NC
4	1	18-42835	Rear Weight Kit, 9RX Scraper
5	1	43-42847	Pin, Drawbar
6	2	44-42831	Plate, Washer
7	2	44-42832	Plate, Weight Lock
8	12	44-42845	Plate, Weight
9	8	57-20819	1" Flat Washer Heavy Duty Gr 8
10	4	57-3098	1.05" ID x 2.50" OD - JD Axle Mount Washer
11	8	70-20609	1" Hex Center Lock Nut Gr.2 NC
12	1	70-20868-1	12mm Hex Top Lock Nut 1.75 Pitch Class 10

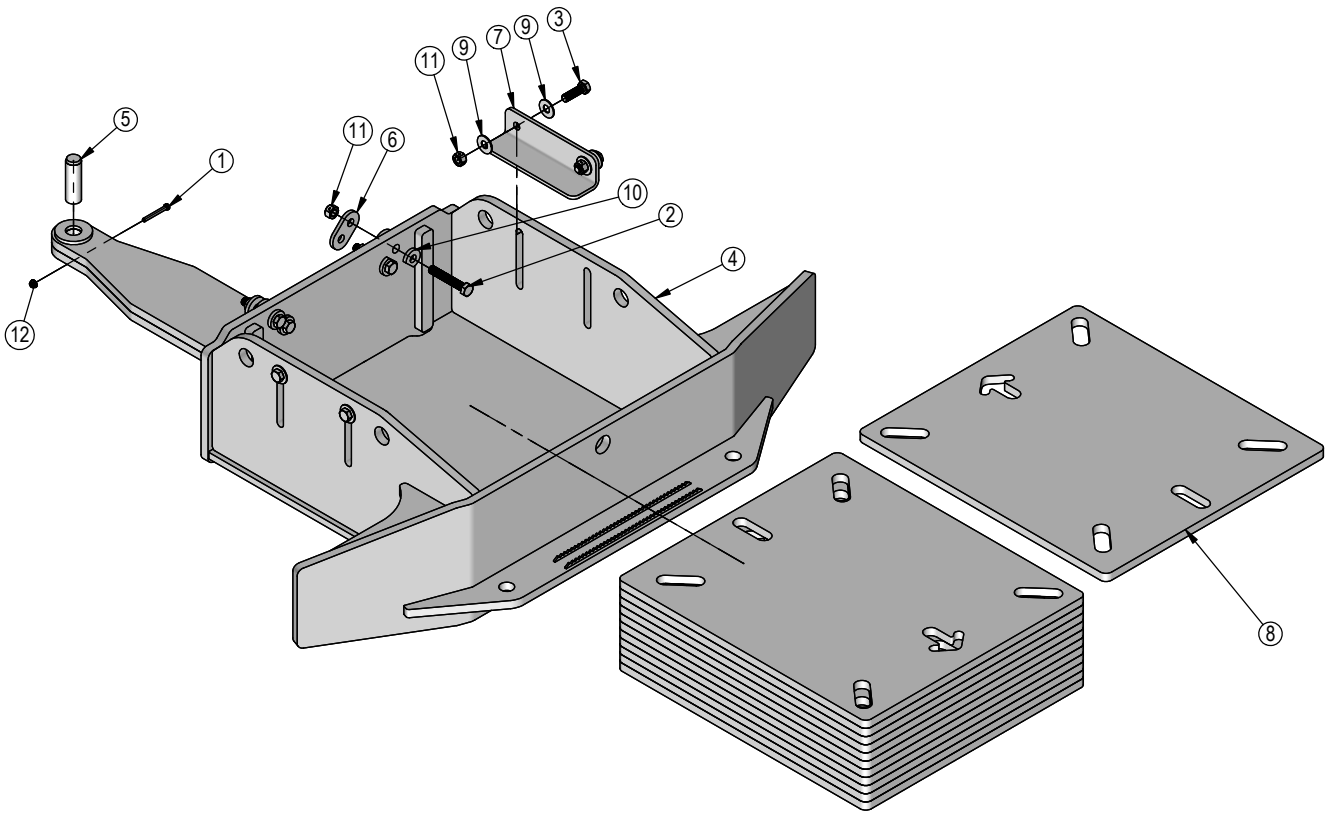

Contact Us

As always, if you have any questions about your product made by Grouser, feel free to contact us.

Grouser Products

755 2nd Ave NW - West Fargo, ND 58078

Phone: 1-800-747-6182

Fax: 1-701-282-8131

E-mail: grouser@grouser.com

Website: www.grouser.com

Improvements

Grouser Products Inc. is continually striving to improve its products. We reserve the right to change prices, specification, or equipment at any time without notice. We also reserve the right to make improvements or changes when it becomes practical and possible to do so without incurring any obligation to make changes or additions to the equipment sold previously.

Warranty

Grouser Products warrants to the original purchaser of each item that the product be free from defects in material and workmanship under normal use and service for a period of two years. If such equipment is found to be defective within two years, it is the obligation of Grouser Products under this warranty to repair or replace (exclusive of the cost of labor and transportation), any equipment or parts, in the judgment of Grouser Products to be defective in material or workmanship.

All equipment or parts claimed to be defective in material or workmanship must be made available for inspection at the place of business of a dealer authorized to handle the equipment covered by this warranty, or, upon request by Grouser Products, shipped to the Grouser Products factory in West Fargo, North Dakota. Grouser Products shall have no obligation to bear the cost of labor or transportation in connection with replacement or repair of any such defective parts in the setup process.

This warranty covers only defects in material and workmanship. It does not cover depreciation or damage caused by normal wear, accident, improper assembly, improper adjustments, improper maintenance including lack of proper lubrication, or improper use. Therefore, Grouser Products liability under this warranty shall not be effective or actionable unless the equipment is assembled, maintained and operated in accordance with the operating instructions accompanying the equipment. Grouser Products shall have no liability if the equipment has been altered or reworked without the written authorization of Grouser Products.

Grouser Products' parts, which are furnished under this warranty and properly installed, shall be warranted to the same extent as the original parts under this warranty if, and only if, such parts are found to be defective within the original warranty period covering the original equipment.

