



# ***JOHN DEERE 9030***

## ***Ag Pro Undercarriage***

### ***Installation Instructions***

**For Models:**

**JD 9030:** 9230, 9330, 9430, 9530, 9630

Purchase Date
Serial Number
Model Number
Tractor Model
Dealer

# To The Owner

This manual contains information concerning the installation of the undercarriage. You have purchased dependable, long lasting equipment, but only by proper care and operation can you expect to receive the performance and long service built into our products. Please have all operators read this manual carefully and keep the manual available for ready reference. If you have any questions or concerns, contact Grouser Products.

## Caution:

- Always use caution when working around any equipment.
- Always wear safety glasses.
- Follow tractor manufacturer's safety guidelines when installing this product.
- Use paint where necessary to prevent rust.
- Do not modify or permit anyone else to modify or alter the equipment and its components without first consulting Grouser Products.

## Note:

- When installing hardware, only finger tighten until all hardware is in place.
- A full diagram of the assembly with the full list of parts is on pages 4-5.
- Unstrap and remove any components that are attached for shipping.
- Read all instructions prior to performing installation.
- Tractor frame not shown in some diagrams for clarity.

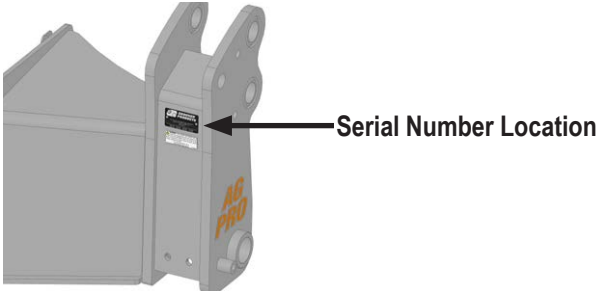

 To ensure the safety of those working under and around the machine, apply parking brake, and remove key from ignition before working on the machine.

## Installation

1. If applicable, remove front weights, weight bracket, toolbox and front axle brace from front of tractor.

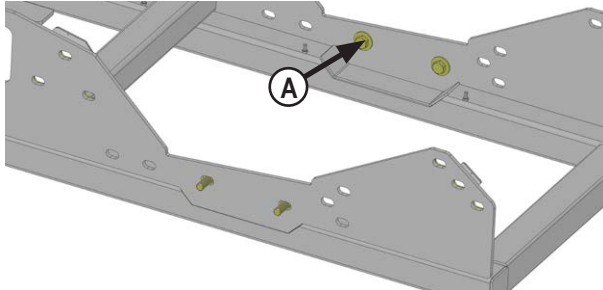

2. Install 4 - 7/8" x 2-1/2" bolts and 4 - 7/8" flat washers in 2 holes on each side above the tube cut out (A). There is very little room once undercarriage is installed on tractor.
3. Position undercarriage under tractor and center on frame of tractor. Lift undercarriage until holes of undercarriage line up with holes in side of tractor frame.

**NOTE:** When lifting the undercarriage, watch for any potential pinching of hoses or any other components to prevent any damage.

**NOTE:** Add shims between undercarriage and tractor frame to reduce any gap if necessary. Use shims until there is a gap of 1/16" or less on front. See attached diagram on Page 4-5 for the proper location and orientation of each shim. Do Not put all of the shims on one side of the undercarriage. If 3 shims are needed, place 2 on one side and 1 on the other.

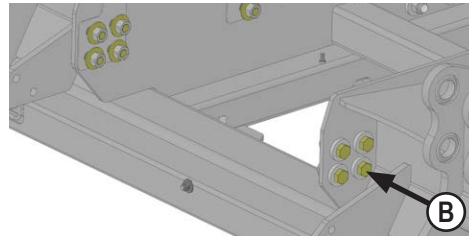

4. Attach front of undercarriage to tractor with 8 - 7/8" x 2-1/2" bolts, 8 - 7/8" heavy washers, shims if needed, 8 - 7/8" flat washers and 8 - 7/8" nuts (B).

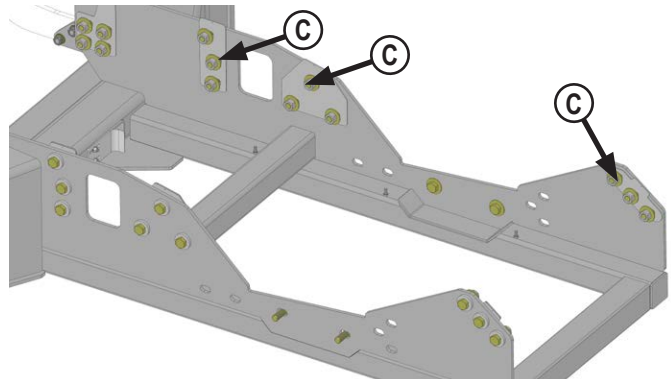

5. Install 18 - 7/8" x 2-1/2" bolts, 18 - 7/8" heavy washers, shims if needed, 18 - 7/8" flat washers and 18 - 7/8" nuts into remaining side slots of undercarriage (C).

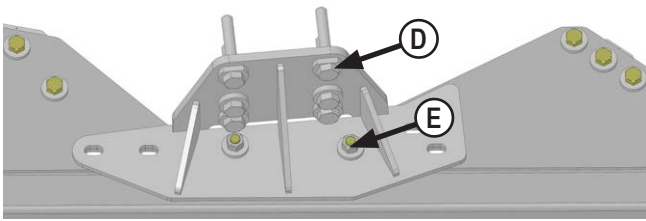

6. Install axle brackets to bottom of axle with 12 - 24mm x 150mm bolts, 12 - 1.05" ID heavy washers (D).
7. Attach axle brackets to undercarriage with bolts from Step #2 and 4 - 7/8" heavy duty washers and 4 - 7/8" nuts (E).

**NOTE: Some tractors have 4 holes in axle. The installation instructions are still compatible but only use 4 bolts and washers instead of 6 as shown in Step #6.**

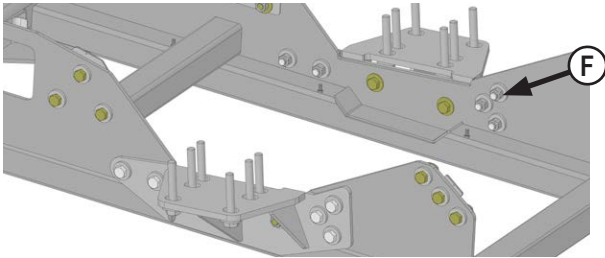

8. Install remaining 10 - 7/8" x 2-1/2" bolts, 20 - 7/8" heavy duty washers and 10 - 7/8" nuts to finish attaching axle brackets to undercarriage (F).

9. Torque 7/8" bolts (A, B, C, E & F) to 600 ft-lbs.

10. Torque 24mm axle bolts (D) to 909 ft-lbs.

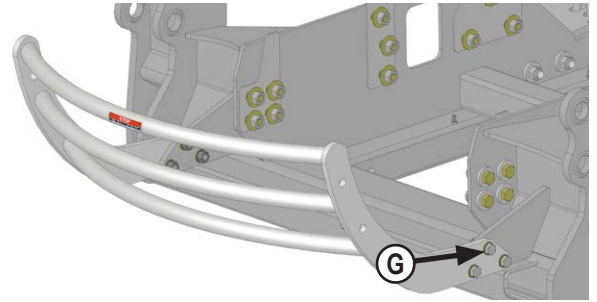

11. Install the grill guard to front of undercarriage with 6 - 3/4" x 2-1/2" bolts, 12 - 3/4" flat washers and 6 - 3/4" nuts (G).
12. Torque 3/4" bolts (G) to 257 ft-lbs.

## Hose Routing

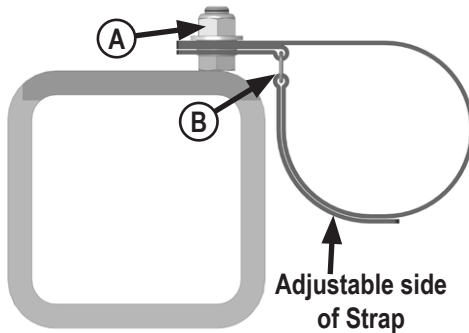

1. Attach a velcro hose strap on every bolt along tubes on undercarriage with a 3/8" flange nyloc nut (A). Assemble strap with the metal loop on bottom side as shown (B). Keep straps open.

**NOTE: Orientation of velcro strap is important and is shown in above photos.**

**NOTE: Quantity of hoses is dependent on which blade system is being used.**



2. Route hoses along undercarriage tubes and secure with velcro straps (C).

**NOTE: While grouping hoses together, do not cross hoses over each.**

3. Route hoses through tractor. Secure hoses with zip ties where necessary to avoid rubbing and pinch areas. Plug hoses into open SCV's at back of tractor.
4. Turn and articulate tractor in both directions to verify hoses have enough slack and are not being pinched around pivot area. Adjust hoses and velcro straps if necessary.

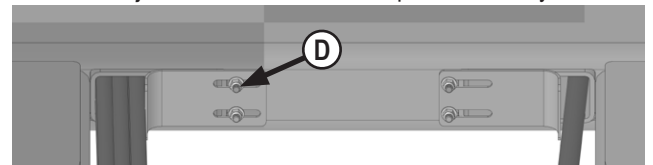

5. Attach hose cover plates to undercarriage with 4 - 3/8" flange nyloc nuts (D). Slide plates until snug against hoses and tighten nuts.

**NOTE: Some parts on undercarriage are not shown for clarity.**

## Assembling Lift Components

1. Refer to the Blade Owner's Manual & Parts Book for instructions on how to assemble the lift components.

## Maintenance

1. After first 8 hours of use, re-torque all bolts.
2. Check all fasteners regularly to ensure proper operation of equipment.
3. Inspect all equipment for existing or potential damages every 10 hours or less.

PART NO.	QTY.	DESCRIPTION
11846	3	Plate,Front
11847	3	Plate, Mid-Front
11848	3	Plate, Mid-Rear
11849	3	Plate, Rear
15380-R	1	Bracket, Axle Weld
15380-L	1	Bracket, Axle Weld
18059	1	Grill Guard Weld
1875	12	24mm x 3.00mm x 150mm Hex Bolt
18882	1	Not For Pushing or Pulling Decal
18887	1	Made in 'Merica
20124	4	1/2" X 1" Hex Bolt Gr 5 NC CZ
20220	6	3/4" X 2-1/2" Hex Bolt Gr 5 NC CZ
20540	30	7/8" X 2-1/2" Hex Bolt Gr 8 NC YZ
20542	10	7/8" X 3" Hex Bolt Gr 8 NC YZ
20598	40	7/8" Hex Nut Gr 8 NC CZ
20604	1	1/2" Hex Center Lock Nut Gr 5 NC CZ
20607	6	3/4" Hex Center Lock Nut Gr 5 NC CZ
20744	5	1/2" Flat Washer CZ
20757	12	3/4" SAE Hardened Flat Washer - 1-1/2" OD
20818	30	7/8" Flat Washer Heavy Duty Gr 8 (USS) YZ
3098	12	1.05" ID x 2.50" OD - JD Axle Mount Washer
3681	50	7/8" ID x 2-1/4" OD x .375" Heavy Washer
40504	1	Plate, Cover
40962	1	Warning Prop 65 Decal
40983	2	Ag Pro
44131	2	Plate, Hose Cover
44315	4	3/8" Nyloc Flange Nut Gr N5 NC
44525	1	JD 9030 Undercarriage Weld
9506	1	Serial Number Tag

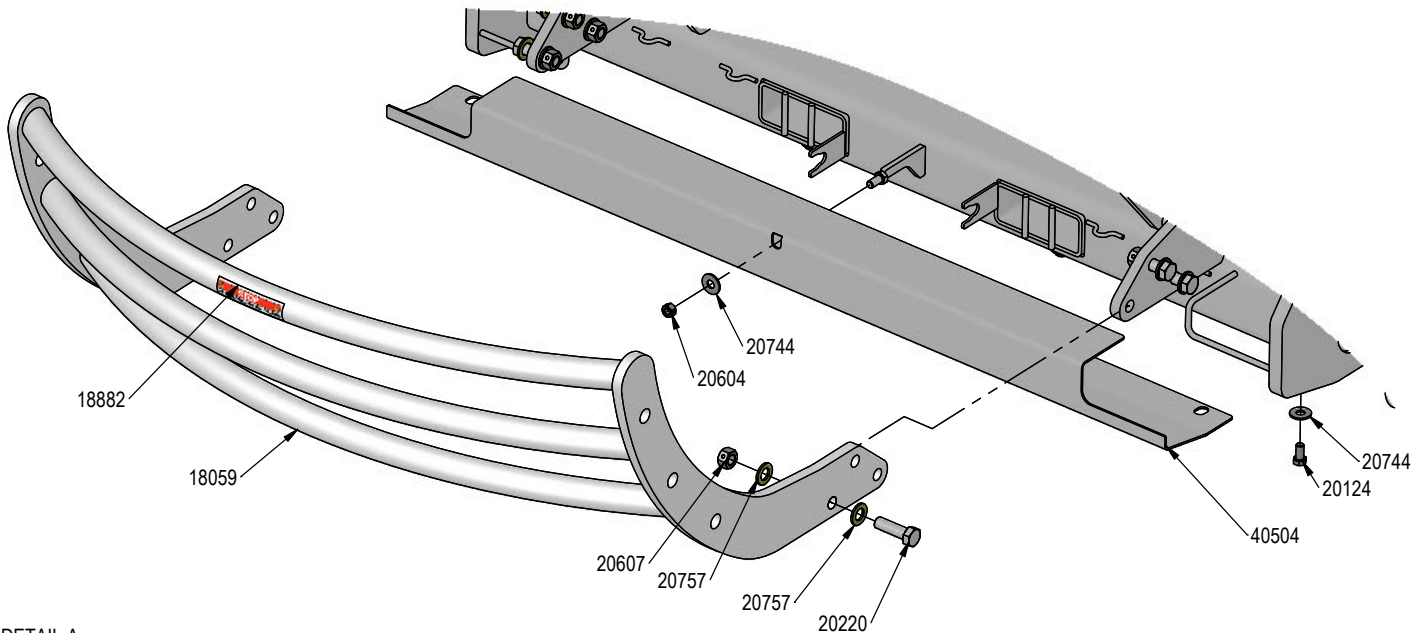
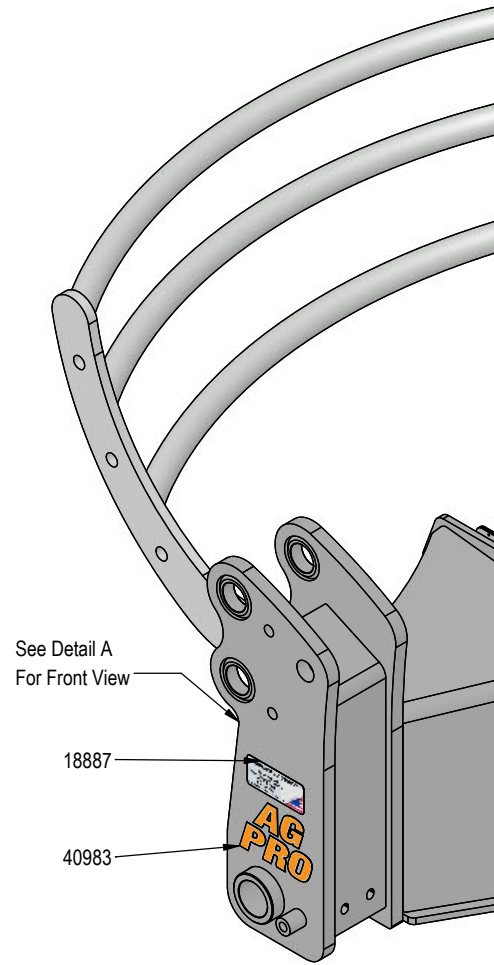

DETAIL A

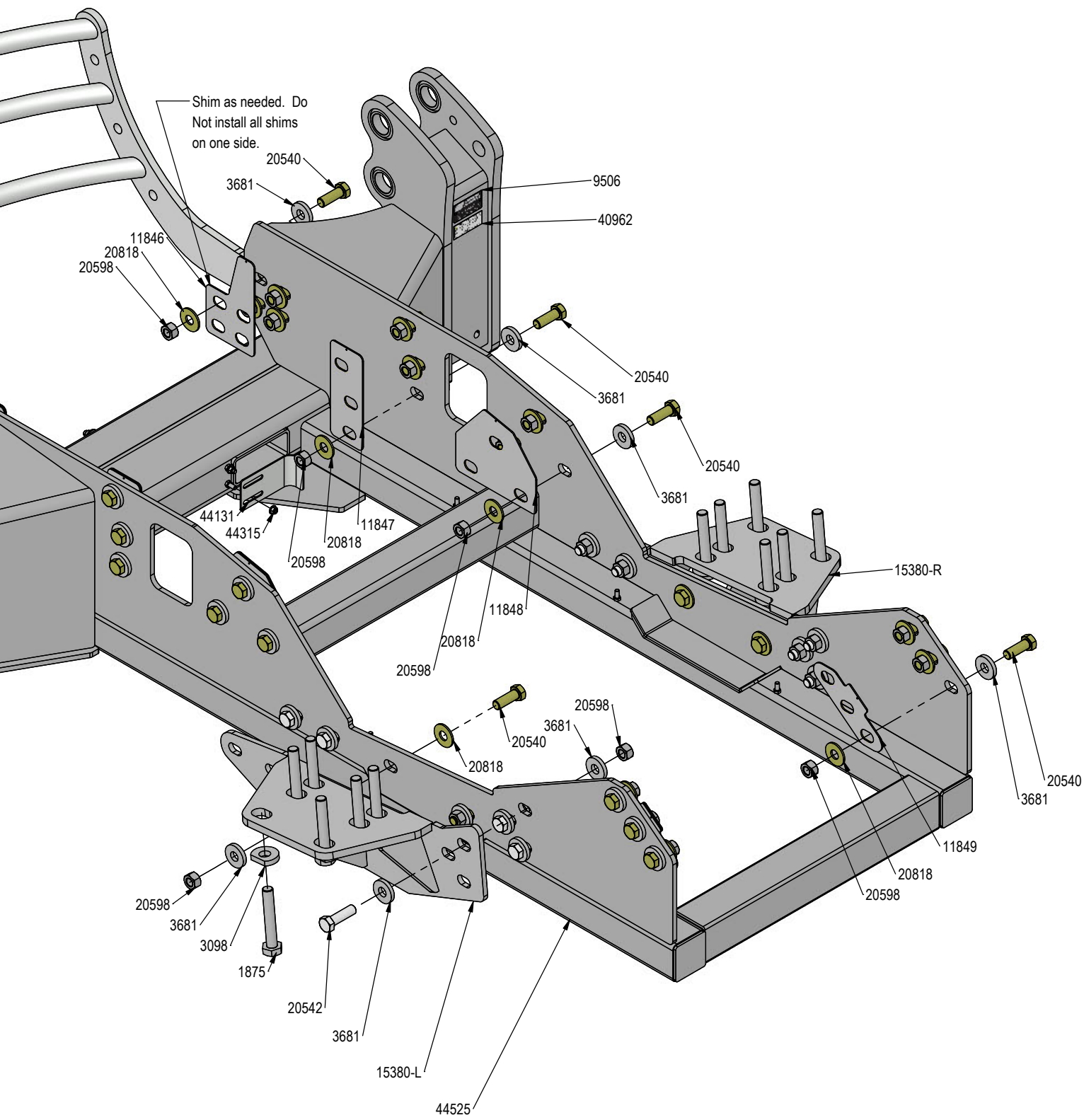

DWG. NO.: 44525-A





# Improvements

---

---

Grouser Products Inc. is continually striving to improve its products. We reserve the right to change prices, specification, or equipment at any time without notice. We also reserve the right to make improvements or changes when it becomes practical and possible to do so without incurring any obligation to make changes or additions to the equipment sold previously.

## Warranty

---

---

Grouser Products warrants to the original purchaser of each item that the product be free from defects in material and workmanship under normal use and service for a period of **two (2) years for Agriculture Series Blades and one (1) year for Heavy Duty Series from date of original retail delivery.**

### The obligation of the consumer under this warranty:

1. To read the operators manual and to operate, lubricate, maintain and store equipment in accordance with the instructions listed in the operators manual.
2. To inspect equipment and if any part needs repair or replacement when continued use would cause damage or wear to other parts or safety.
3. All equipment or parts claimed to be defective in material or workmanship must be made available for inspection at the place of business of a dealer authorized to handle the equipment covered by this warranty, or, upon request by Grouser Products, shipped to the Grouser Products factory in West Fargo, North Dakota.

### The obligation of the dealer under this warranty:

1. Complete warranty registration form and submit within 30 days of sale.
2. Contact Grouser Products for authorization prior to performing any warranty repairs or part replacement.
3. Complete warranty request form and submit with photos and supporting documentation.

### The obligation of Grouser Products under this warranty:

1. Repair or replace, any equipment or parts, in the judgment of Grouser Products to be defective in material or workmanship.
2. Grouser Products will cover the cost of parts and ground shipping at dealer invoice only.
3. Grouser Products shall have no obligation to bear the cost of labor or transportation in connection with replacement or repair of any such defective parts.

### This warranty does not cover:

1. Depreciation or damage caused by normal wear, accident, improper assembly, improper adjustments.
2. Improper maintenance including lack of proper lubrication, or improper use. Including loose bolts, nuts, or fitting due to over tightening or vibration after 20 hours of operation.
3. Repairs or alterations without authorization from a Grouser Products representative.
4. Grouser Products shall have no liability if the equipment has been altered or reworked without the written authorization of Grouser Products.

Grouser Products' parts, which are furnished under this warranty and properly installed, shall be warranted to the same extent as the original parts under this warranty if, and only if, such parts are found to be defective within the original warranty period covering the original equipment.

**NO EMPLOYEE OR REPRESENTATIVE OF GROUSER PRODUCTS IS AUTHORIZED TO CHANGE THE WARRANTY IN ANY WAY OR GRANT ANY OTHER WARRANTY.**

## Contact Us

---

---

As always, if you have any questions about your system or other products made by Grouser, feel free to contact us.



755 2nd Ave NW - West Fargo, ND 58078  
+1 701-282-7710 | info@grouser.com  
www.grouser.com