



# Ag Pro XWide Lift

## Owner's Manual & Parts Book

**Grouser Products**

755 2nd Ave NW - West Fargo, ND 58078

**Phone:** 1-701-282-7710

**Fax:** 1-701-282-8131

**E-mail:** [info@grouser.com](mailto:info@grouser.com)

**Website:** [www.grouser.com](http://www.grouser.com)

Purchase Date
Serial Number
Model Number
Tractor Model
Dealer

Description	Page
Welcome To The Owner_____	2
Safety Precautions, Torque Specifications & Pre-Installation _____	3
Decals _____	4
Maintenance & Lubrication_____	4
Full System_____	5
Lift System_____	6
Tractor Side Hydraulics & Initial Startup_____	7-11
Hydraulic Schematics_____	12
Hydraulic Multi-Coupler Maintenance _____	13-15
Troubleshooting Multi-Coupler Connections _____	15
Contact Us, Improvements, & Warranty _____	16

Thank you for your recent purchase of a Grouser Ag Pro Dozer. Welcome to the family of satisfied Grouser blade owners. Grouser Products is committed to offering quality products to help professionals in their daily jobs. We are also committed to providing you the highest level of customer satisfaction possible. Again, thank you for your patronage. We look forward to serving you.

This manual contains information concerning the operation, adjustment, safety and maintenance of the Ag Pro Dozer. You have purchased a dependable, long lasting piece of equipment. You can expect to receive long lasting performance and long service built into our products with proper care and operation. Please have all operators read and understand this manual carefully. Keep the manual available for reference. If, for any reason, you have questions or comments, we would be happy to hear from you. Call our number, 701-282-7710, or send us an e-mail at [info@grouser.com](mailto:info@grouser.com). You can expect us to respond to your e-mail in a timely manner.

HAHT	Hydraulic Angle - Hydraulic Tilt
HANT	Hydraulic Angle - No Tilt
NAHT	No Angle - Hydraulic Tilt
NANT	No Angle - No Tilt

A careful operator is the best operator. Most accidents can be avoided by observing certain precautions. To help prevent accidents, read and take the following precautions before operating this equipment. In addition, please follow all safety and operational instructions of your tractor manufacturer.

### The Ag Pro Dozer:

1. The Ag Pro Dozer should be operated only by those who are responsible and instructed to do so.
2. Read the owner's manual carefully before using this equipment. Lack of operating knowledge can lead to accidents.
3. Keep the Ag Pro Dozer maintained in reliable and satisfactory condition to ensure your safety.
4. Make sure the area is clear of people before moving any equipment.
5. Do not modify or permit anyone else to modify or alter the equipment and its components without first consulting Grouser Products.
6. Lower the blade to the ground when not in use.

### Servicing the Ag Pro Dozer:

1. Read and follow all safety instructions provided by the tractor manufacturer.
2. Always use proper personal safety gear when performing maintenance on equipment.
3. Before servicing, relieve hydraulic pressure, stop engine and fully engage parking brake.
4. Escaping hydraulic fluid under pressure can penetrate skin causing serious injury. If fluid is injected into skin, obtain medical attention immediately.
  - DO NOT use your hand to check for leaks. Use a piece of cardboard or paper to search for leaks.
  - Stop the engine and relieve pressure before connecting or disconnecting lines.
  - Tighten all connections before starting the engine or pressurizing lines.

### Storing the Ag Pro Dozer:

1. Thoroughly clean the Ag Pro Dozer before storage. Use paint where necessary to prevent rust.
2. Check the Ag Pro Dozer for worn or damaged parts. Install new parts as required.
3. Lubricate all pins and joints.

Tighten all bolts to the values listed below unless otherwise noted. Refer to the parts lists for proper length and grade of the bolts.

Size	Torque - Dry (ft-lbs)			
	SAE Grade 5		SAE Grade 8	
	UNC	UNF	UNC	UNF
5/16	17	19	24	27
3/8	30	35	45	50
7/16	50	55	70	80
1/2	75	85	110	120
9/16	110	120	150	170
5/8	150	170	210	240
3/4	260	300	380	420
7/8	430	470	600	670
1	640	720	910	1020

Size	Torque - Dry (ft-lbs)
	Grade 10.9
M18 x 2.50	284
M20 x 2.50	401
M22 x 2.50	547
M24 x 3.00	694

Unstrap and remove the lift frame, hoses, top arms, and any boxes of hardware from the undercarriage. If any components are missing, call Grouser.

Install undercarriage per the tractor specific mounting instructions.

**WARNING**  
 CLEAN MALE AND FEMALE COUPLERS PRIOR TO CONNECTING. CONTAMINATION CAUSES LEAKS AND IS NOT WARRANTABLE.  
 27-45413R1

PN: 27-45413

# GROUSER

PN: 27-9504

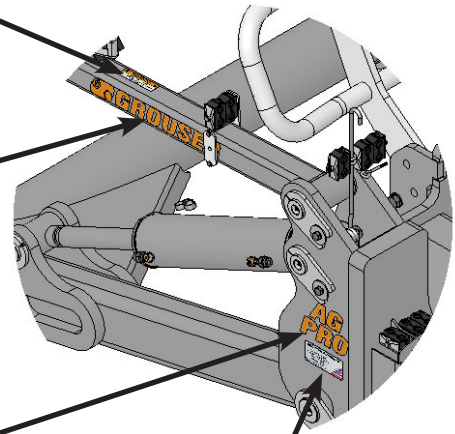

# AG PRO

PN: 27-40983

**GROUSER PRODUCTS**  
 755 2nd Ave NW-West Fargo, ND 58078  
 800-747-6182/701-282-7710  
 1020XXXX  
 This product may be protected by one or more of the following patents and trademarks:  
 6431288 6422322 2227998 2227996  
 6827155 6907941 6955229 7131502

PN: 27-9506

**WARNING:** This product can expose you to chemicals including lead and lead compounds, mineral oils, and phthalates which are known to the State of California to cause cancer and birth defects or other reproductive harm.  
 For more information go to [www.P65Warnings.ca.gov](http://www.P65Warnings.ca.gov) 27-40962R1

PN: 27-40962

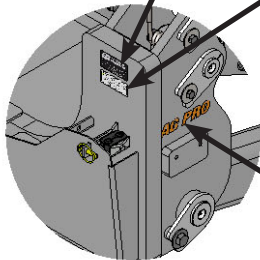

# AG PRO

PN: 27-44651

**GROUSER PRODUCTS**  
  
 755 2nd Avenue NW  
 West Fargo, ND 58078  
 701.282.7710  
 Grouser.com  
 Proudly Engineered & Manufactured in the USA  
 27-18887

PN: 27-18887

Due to the harsh environment this equipment operates in, the following tasks should be performed every 10 hours or less.

- Inspect all equipment before operation for existing or potential damage.
- Lubricate all joints with high quality grease. See below for grease locations.
- Inspect all bolts, and tighten any loose bolts to torque specifications on page 3.
- Check hydraulic cylinders and hoses for damage or leaks. For replacement parts, see hydraulic pages 6-11.
- Make sure all non-rotating pins are secured properly.
- Inspect all decals and order replacement decals from your dealer if any are damaged or worn.
- For multi-coupler maintenance, see pages 13-15.
- Replace parts with original parts only.

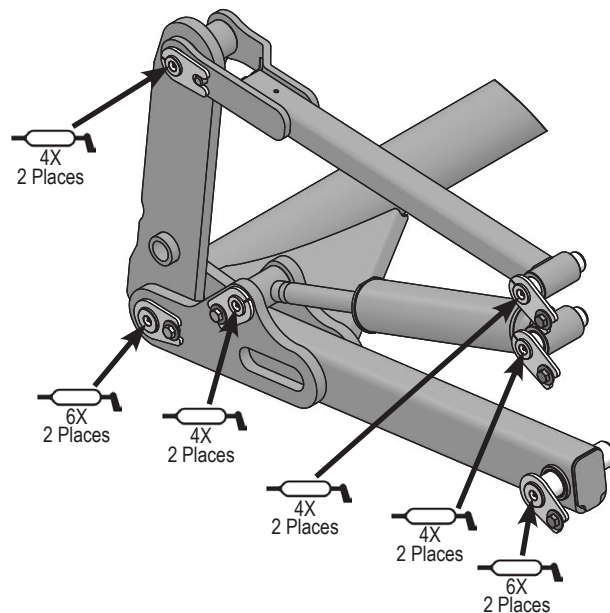

PART NO.	QTY	DESCRIPTION
43530	1	Lift System Assembly
44800-A	1	Undercarriage Assembly
XXXXX	1	Tractor Side Hydraulics

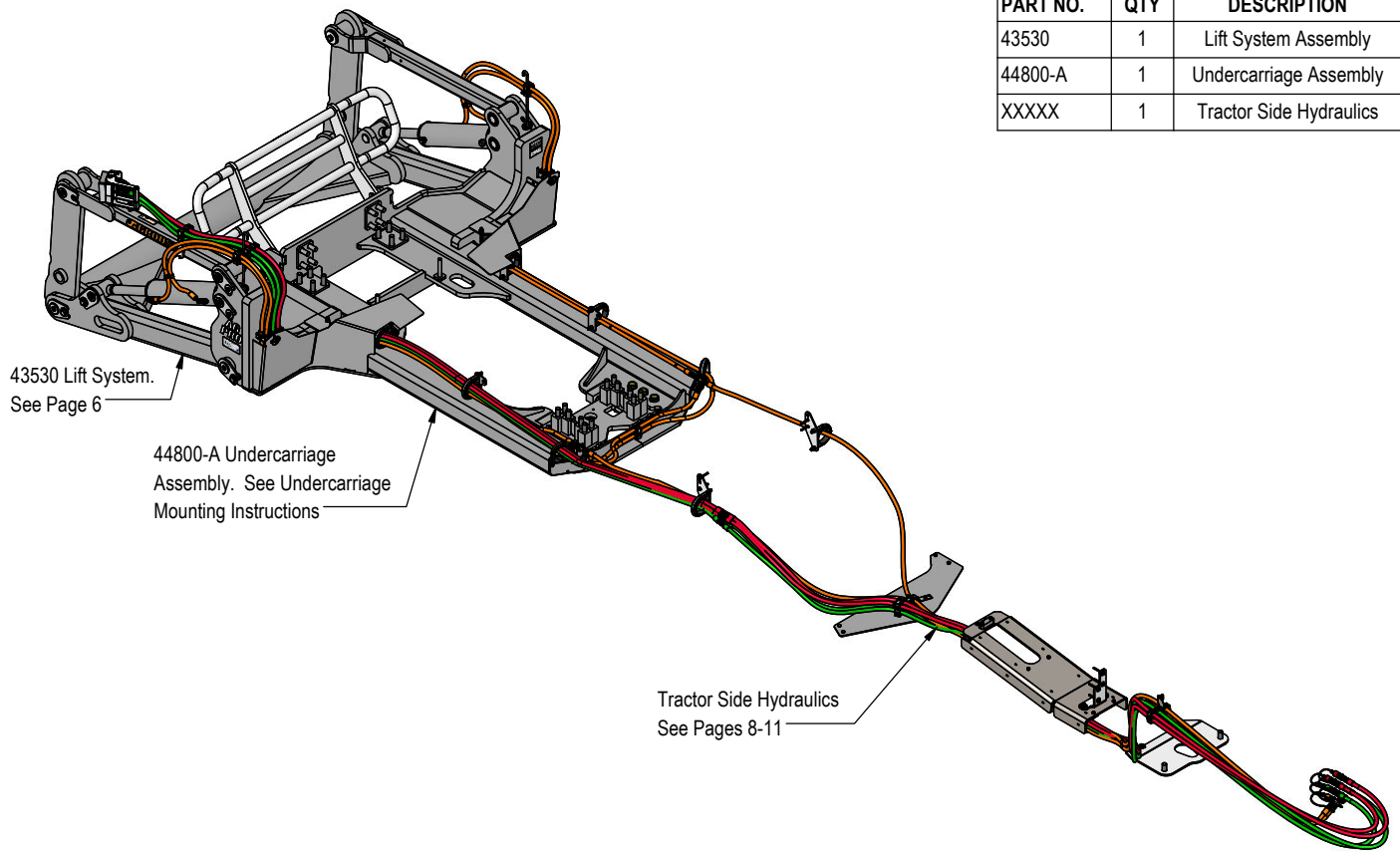

Some assembly of Lift System components is necessary. Follow the steps listed below. See diagram below for the correct hardware and orientation of parts.

1. Remove all pins and fasteners on each side of the undercarriage and set aside for later installation.
2. Position the lift frame between the two plates on both sides of the undercarriage and align to the bottom holes.
3. Insert pins and hardware to attach the lift frame, the base end of the lift cylinders, and the top arms to the undercarriage.
4. Insert pins and hardware to attach the male quick attaches to the lift frame, and to the top arms. Use 2" washers as shims to keep top arm pins tight and in place. Only use as many as needed until pin is tight while still allowing top arm to rotate.
5. Torque all fasteners according to the specifications on Page 3.

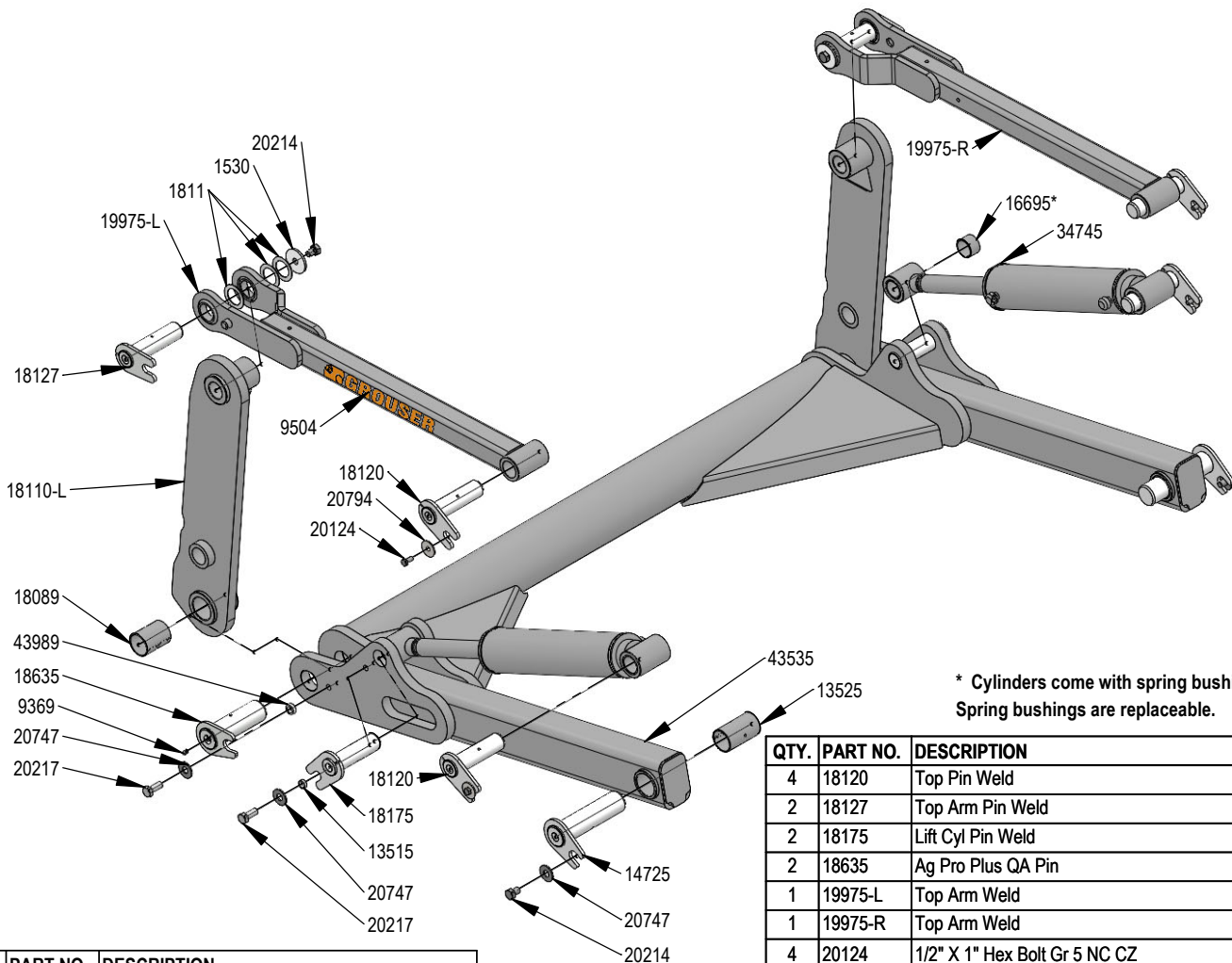

\* Cylinders come with spring bushings. Spring bushings are replaceable.

QTY.	PART NO.	DESCRIPTION
2	1530	3/4" x 3".00 x .25" HD Washer CZ
6	1811	2" Washer
12	9369	Straight 1/8" NPT Grease Zerk
2	13515	Spacer, NR Pin
2	13525	2.75 x 2.50 x 4.75 Spring Bushing
2	14725	Lift Frame / UC Pin
8	16695	2.25 x 2.00 x 1.50 Spring Bushing
2	18089	2.75 x 2.50 x 3.75 Spring Bushing
1	18110-L	Male Quick Attach, Ag Pro S
1	18110-R	Male Quick Attach, Ag Pro S

QTY.	PART NO.	DESCRIPTION
4	18120	Top Pin Weld
2	18127	Top Arm Pin Weld
2	18175	Lift Cyl Pin Weld
2	18635	Ag Pro Plus QA Pin
1	19975-L	Top Arm Weld
1	19975-R	Top Arm Weld
4	20124	1/2" X 1" Hex Bolt Gr 5 NC CZ
4	20214	3/4" X 1" Hex Bolt Gr 5 NC CZ
4	20217	3/4" X 1 3/4" Hex Bolt Gr 5 NC CZ
6	20747	3/4" Flat Washer CZ
4	20794	1/2" Fender Washer (2.00" OD x .500" ID x .125")
2	34745	4.5 x 18 Cylinder
1	43535	Lift Frame, SS Wide Angle
2	43989	.75 x 1.25 NR Pin Bushing
2	9504	Grouser Horizontal Decal

**Note:** The cylinder part number is stamped on the base end of the cylinder opposite of the hydraulic ports.

No. On Cylinder	Part No.	Description	DWG. NO.: 43530
26-34745	49-12278	Seal Kit 4.5 (658366) Nitrided Rod	

**Note: Refer to Pages 8-9 for the correct hose lengths and hose location.**

**Note: All connections are identified by spiral bands. 2 bands are from the base end of a cylinder and 1 band is from the rod end of a cylinder. Orange = Lift, Green = Tilt and Red = Angle.**

1. Connect the lift hoses to the lift cylinders.
2. Verify that hoses are not twisted and protected from rubbing on any sharp edges. See Pages 8-11 for proper hose routing.
3. Attach the multi-coupler to the top arm mount and install the 45° fittings.
4. Identify each remaining hose at the front of the undercarriage by the colored bands on end of hose and connect hose to corresponding 45° fitting on multi-coupler. Refer to Pages 8-11 for proper hose locations.
5. Hoses were plugged into the rear of the tractor during the undercarriage installation.
6. Continue on below for initial startup instructions.

Prior to operating the blade system, all air must be purged from the hydraulic system. Follow the steps below for each function on your blade.

**Lift Function:**

1. With the lift frame down and blocked, loosen the fittings on both ends of the lift cylinders.
2. Actuate the raise function to supply oil to the rod end of the cylinders.
3. When oil starts to flow from the fittings, stop oil flow, and tighten the fitting on the rod end of the lift cylinders.
4. Continue to flow oil until the system is fully raised and then block the lift frame.
5. Actuate the function in the opposite direction to supply oil to the base end of the lift cylinders.
6. When all air is removed from the lift system, stop oil flow and tighten the fittings on the base end of the lift cylinders.
7. Raise lift system and remove blocks. Cycle up and down 5 more times.
8. Check tractor oil level and fill if necessary.

If lift function does not operate correctly, start over with Step #1 above and re-bleed. If problem still persists, call Grouser Products.

ITEM NO.	PART NO.	HANT QTY.	NAHT QTY.	DESCRIPTION
1	16-812520	2	2	M8-1.25 x 20mm Class 10.9 Hex Bolt CZ
2	25-19868	1	1	Multi-Coupling Plate - 2 Port - Fixed
3	25-19871	1	1	Multi-Coupling Plate - 2 Port - Cap
4	57-20740	2	2	1/4" Flat Washer CZ

**HANT**

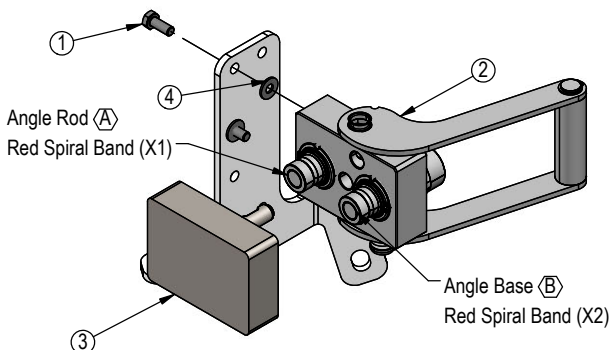

**NAHT**

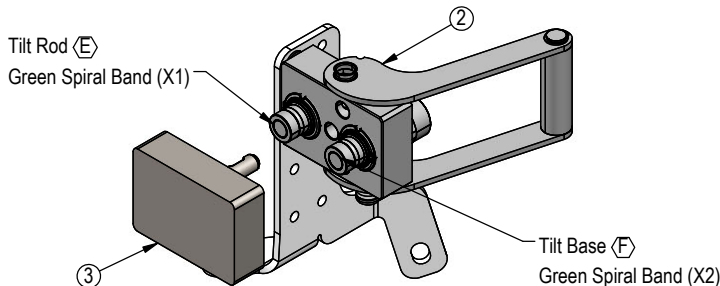

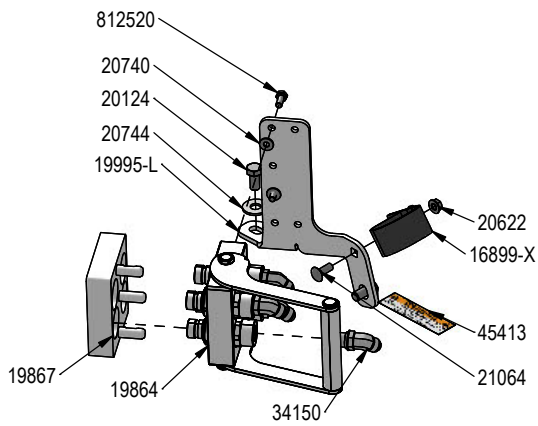

DETAIL A  
SCALE 1 : 10

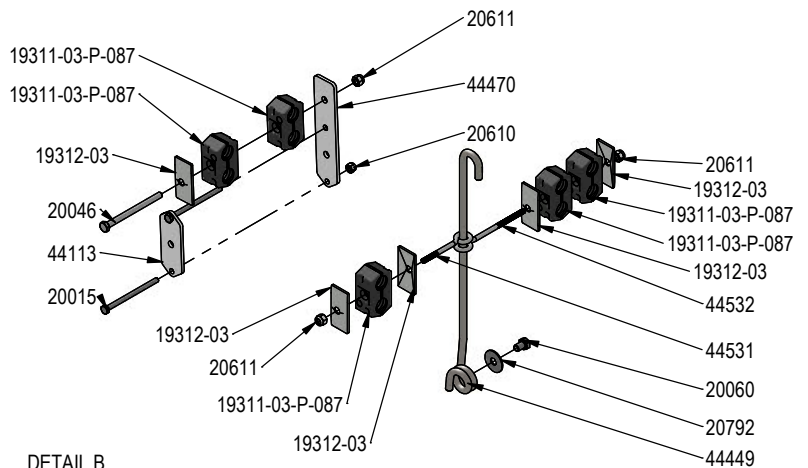

DETAIL B  
SCALE 1 : 10

**NOTE:** Every hydraulic function from front to back of system is designated by a letter and can also be referenced on the Hydraulic Schematic.

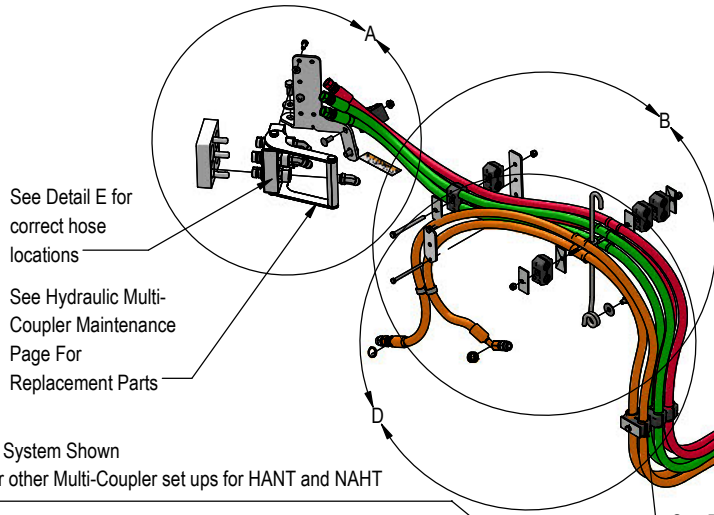

**NOTE:** HAHT System Shown  
See Page 7 for other Multi-Coupler set ups for HANT and NAHT

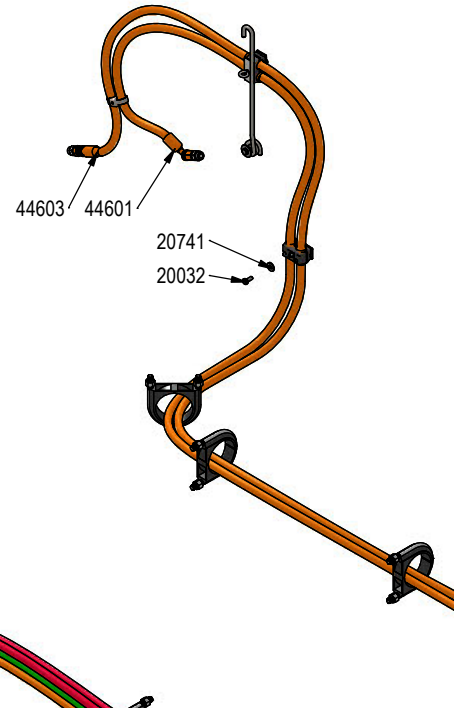

DETAIL D  
SCALE 1 : 10

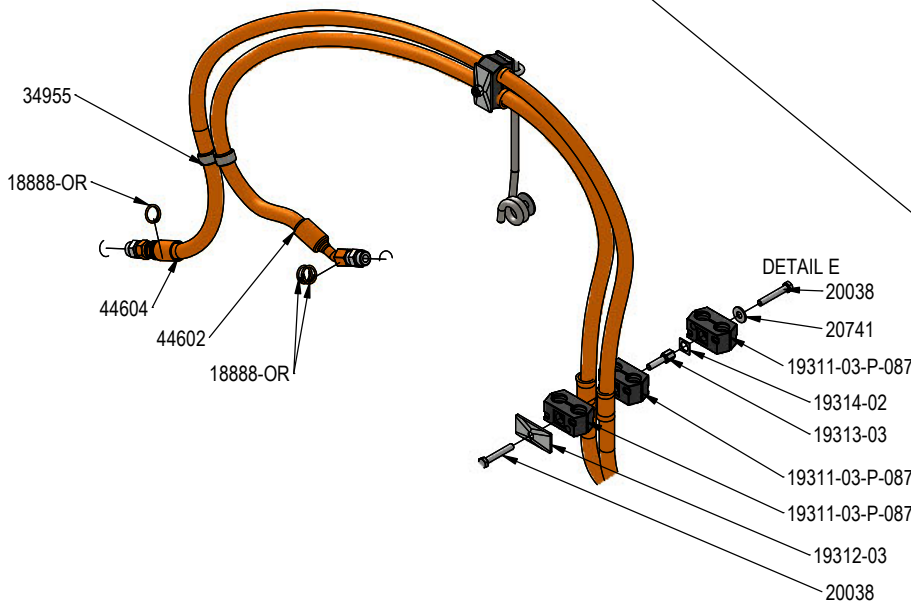

DETAIL E

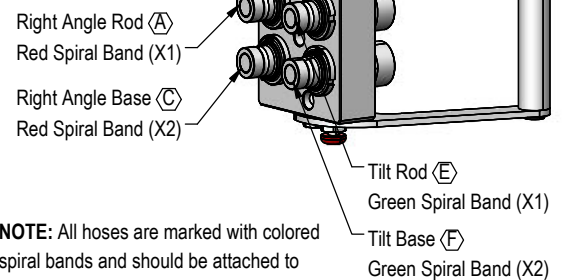

**NOTE:** All hoses are marked with colored spiral bands and should be attached to designated ports on the Multi-Coupler.

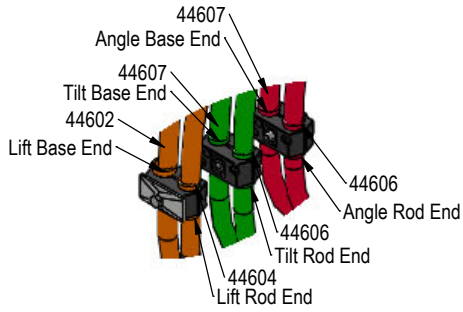

DETAIL C  
SCALE 1 : 8

PART NO.	HAHT QTY.	HANT QTY.	NAHT QTY.	NANT QTY.	DESCRIPTION
16899-4	-	1	1	-	4" Heavy Duty Velcro Strap (HS404H)
16899-6	1	-	-	-	6" Heavy Duty Velcro Strap (HS406H)
18888-GR	6	-	6	-	-12 Green - Spiral Band
18888-OR	12	12	12	12	-12 Orange - Spiral Band
18888-RD	6	6	-	-	-12 Red - Spiral Band
19311-03-P-087	10	7	7	4	Hose Clamp
19312-03	9	9	9	6	Twin Cover Plate
19313-03	1	-	-	-	Twin Stacking Bolt
19314-02	1	-	-	-	Twin Safety Plate
19864	1	-	-	-	Multi-Coupling Plate - 4 Port Fixed
19867	1	-	-	-	Multi-Coupling Plate - 4 Port - Cap
19868	-	1	1	-	Multi-Coupling Plate - 2 Port - Fixed
19871	-	1	1	-	Multi-Coupling Plate - 2 Port - Cap
19995-L	1	1	1	-	Multi-Coupler Mount
20015	2	2	2	-	1/4" X 3-3/4" Hex Bolt Gr 5 NC CZ
20032	1	1	1	2	5/16" X 3/4" Hex Bolt Gr 5 NC CZ
20038	3	3	3	2	5/16" X 2" Hex Bolt Gr 5 NC CZ
20040	-	1	1	-	5/16" X 2-1/2" Hex Bolt Gr 5 NC CZ
20046	1	-	-	-	5/16" X 4" Hex Bolt Gr 5 NC CZ
20060	2	2	2	2	3/8" X 1/2" Hex Bolt Gr 5 NC CZ
20124	2	2	2	-	1/2" X 1" Hex Bolt Gr 5 NC CZ
20610	2	2	2	-	1/4" Nylock Hex Nut Gr 5 NC CZ
20611	4	4	4	2	5/16" Nyloc Hex Nut Gr 5 NC CZ
20622	1	1	1	-	3/8" Flange Hex Nut Gr 5 NC CZ
20740	2	2	2	-	1/4" Flat Washer CZ
20741	2	2	2	2	1/4" Flat Washer CZ
20744	2	2	2	-	1/2" Flat Washer CZ
20792	2	2	2	2	3/8 Fender Washer (1.25" OD)
20807	2	2	2	2	3/4" Hex Jam Nut NF CZ
21064	1	1	1	-	3/8" x 1" Carriage Bolt Gr 5 NC CZ
34030	2	2	2	2	Bulkhead Run Tee JIC
34040	4	4	4	4	Straight JIC x O-Ring
34150	4	2	2	-	Straight Thread Elbow 45° JIC x O-Ring
34955	2	2	2	2	Dual Clamp Zip Tie
42375	8	8	8	8	Cushioned U-Bolt with Nuts
44113	1	1	1	-	Plate, Clamp
44449	2	2	2	2	Hose Guide Rod
44470	1	1	1	-	Plate, Clamp
44531	2	3	3	2	5/16 x 2.50 Eye Bolt
44532	1	-	-	-	5/16 x 4.00 Eye Bolt
44601	1	1	1	1	159" x 1/2" -18FJIC 45° Elbow/-8FJIC Hose (w/2 Collar (37" & 60.50"))
44602	1	1	1	1	195" x 1/2" -18FJIC 45° Elbow/-8FJIC Hose (w/2 Collar (37" & 60.50"))
44603	1	1	1	1	201" x 1/2" -8FJIC/-8FJIC Hose (w/2 Collar (45.5" & 70"))
44604	1	1	1	1	162" x 1/2" -8FJIC/-8FJIC Hose (w/2 Collar (45.5" & 70"))
44606	2	1	1	-	190" x 1/2" -8FJIC/-8MJIC Hose (w/2 Collar (40" & 62"))
44607	2	1	1	-	190" x 1/2" -8FJIC/-8MJIC Hose (w/2 Collar (39" & 59"))
45413	1	1	1	-	Warning Clean Coupler Decal
812520	2	2	2	-	M8-1.25 x 20mm Class 10.9 Hex Bolt CZ

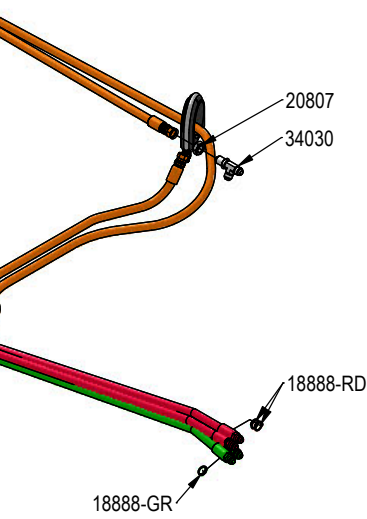

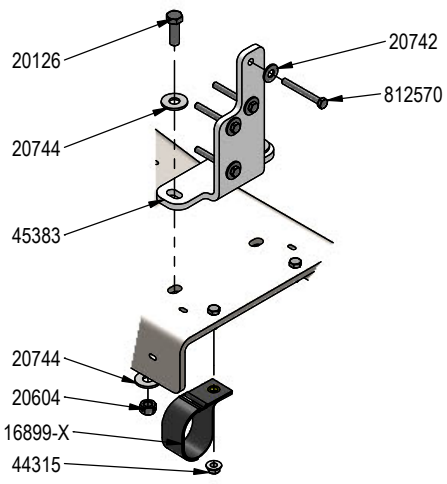

DETAIL A  
SCALE 1 : 10

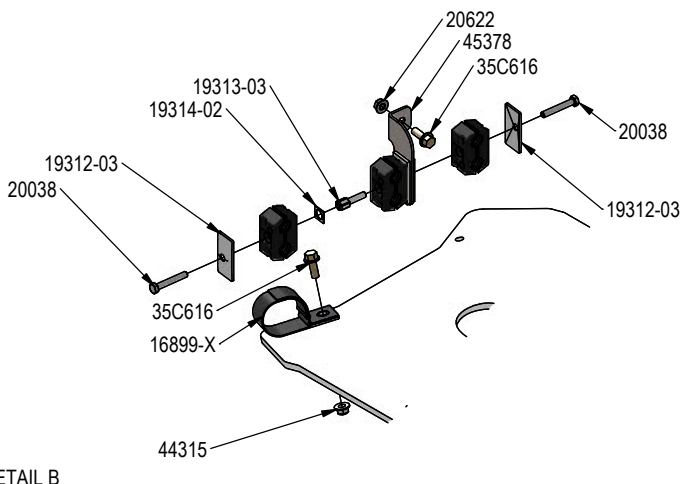

DETAIL B  
SCALE 1 : 10

NOTE: HAHT System Shown

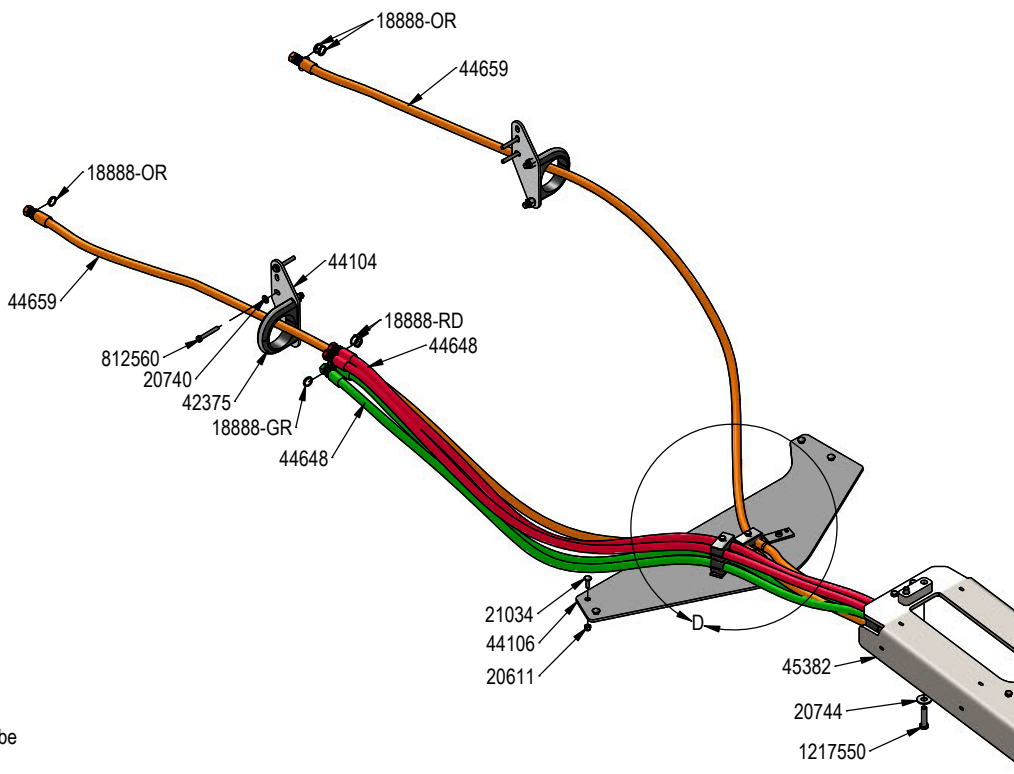

NOTE: All hoses are marked with colored spiral bands and should be attached to designated hoses with same bands.

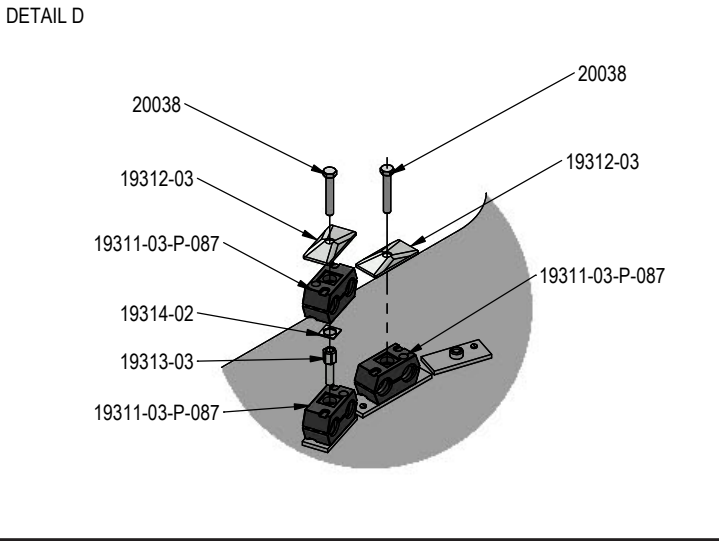

DETAIL D

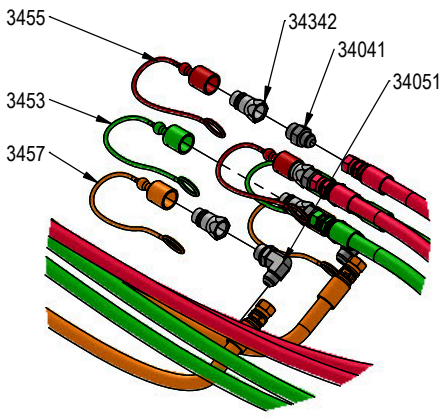

DETAIL C  
SCALE 1 : 10

PART NO.	HAHT QTY.	HANT QTY.	NAHT QTY.	NANT QTY.	DESCRIPTION
35C616	2	2	2	2	3/8" x 1" Flanged Bolt
3453	2	-	2	-	Pioneer Dust Cap Tilt (Green)
3455	2	2	-	-	Pioneer Dust Cap Angle (Red)
3457	2	2	2	2	Pioneer Dust Cap Lift (Orange)
16899-4	-	4	4	4	4" Heavy Duty Velcro Strap (HS404H)
16899-6	4	-	-	-	6" Heavy Duty Velcro Strap (HS406H)
18888-GR	6	-	6	-	-12 Green - Spiral Band
18888-OR	6	6	6	6	-12 Orange - Spiral Band
18888-RD	6	6	-	-	-12 Red - Spiral Band
19311-03-P-075	3	2	2	1	Twin Hose Clamp (TS-CLH-02-P-075)
19311-03-P-087	3	2	2	1	Hose Clamp
19312-03	4	4	4	2	Twin Cover Plate
19313-03	2	-	-	-	Twin Stacking Bolt
19314-02	2	-	-	-	Twin Safety Plate
20038	4	4	4	2	5/16" X 2" Hex Bolt Gr 5 NC CZ
20126	2	2	2	2	1/2" X 1-1/2" Hex Bolt Gr 5 NC CZ
20604	2	2	2	2	1/2" Hex Center Lock Nut Gr 5 NC CZ
20611	4	4	4	4	5/16" Nyloc Hex Nut Gr 5 NC CZ
20622	1	1	1	1	3/8" Flange Hex Nut Gr 5 NC CZ
20740	4	4	4	4	1/4" Flat Washer CZ
20742	4	4	4	4	3/8" Flat Washer CZ
20744	6	6	6	6	1/2" Flat Washer CZ
21034	4	4	4	4	5/16" x 1" Carriage Bolt Gr 5 NC
34041	4	2	2	-	Straight JIC x O-Ring
34051	2	2	2	2	Straight Thread Elbow 90° JIC x O-Ring
34342	6	4	4	2	Tappet Quick Coupler Male
42375	2	2	2	2	Cushioned U-Bolt with Nuts
44104	2	2	2	2	Plate, Hose Loop Mount
44106	1	1	1	1	Tank Plate Weld
44315	4	4	4	4	3/8" Nyloc Flange Nut Gr N5 NC
44648	4	2	2	-	245" x 1/2" -8FJIC/-8FJIC Hose (w/1 Collar (58"))
44659	2	2	2	2	272" x 1/2" -8FJIC/-8FJIC Hose (w/1 Collar (90"))
45377	1	1	1	1	Bracket, Oscillation Hose Mount
45378	1	1	1	1	Bracket, Rear Hose Clamp
45382	1	1	1	1	Center Hose Bracket
45383	1	1	1	1	Mount, Center Hose Bracket
812560	4	4	4	4	M8-1.25 x 60mm Class 10.9 Hex Bolt CZ
812570	4	4	4	4	M8-1.25 x 70mm Class 10.9 Hex Bolt CZ
1217550	2	2	2	2	M12-1.75 x 50mm Class 10.9 Hex Bolt CZ
2430050	2	2	2	2	M24-3.0 x 50mm Class 10.9 Hex Bolt CZ

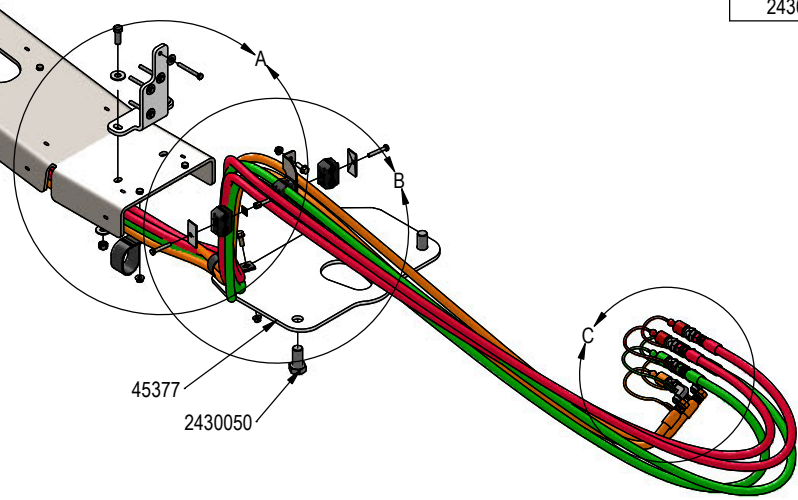

NOTE: 3/4" couplers are available. See table below for part numbers. Quantities are for a set.

PN	Lift Function Set -12 Hoses	Tilt Function Set -08 Hoses	Angle Function Set -08 Hoses	DESCRIPTION
25-44314	2	2	2	Tappet Quick Coupler Male (ISO 7241) - (6610-12-12)
25-45006	2	2	2	Pioneer Dust Cap (Black - 3/4" Couplers) TFA 34 N
31-6801-08-12	2			Straight Thread Elbow 90° JIC x O-Ring (6801-8-12)
31-6400-08-12		2	2	Straight JIC x O-Ring (6400-08-12)

DWG. NO.: 44372

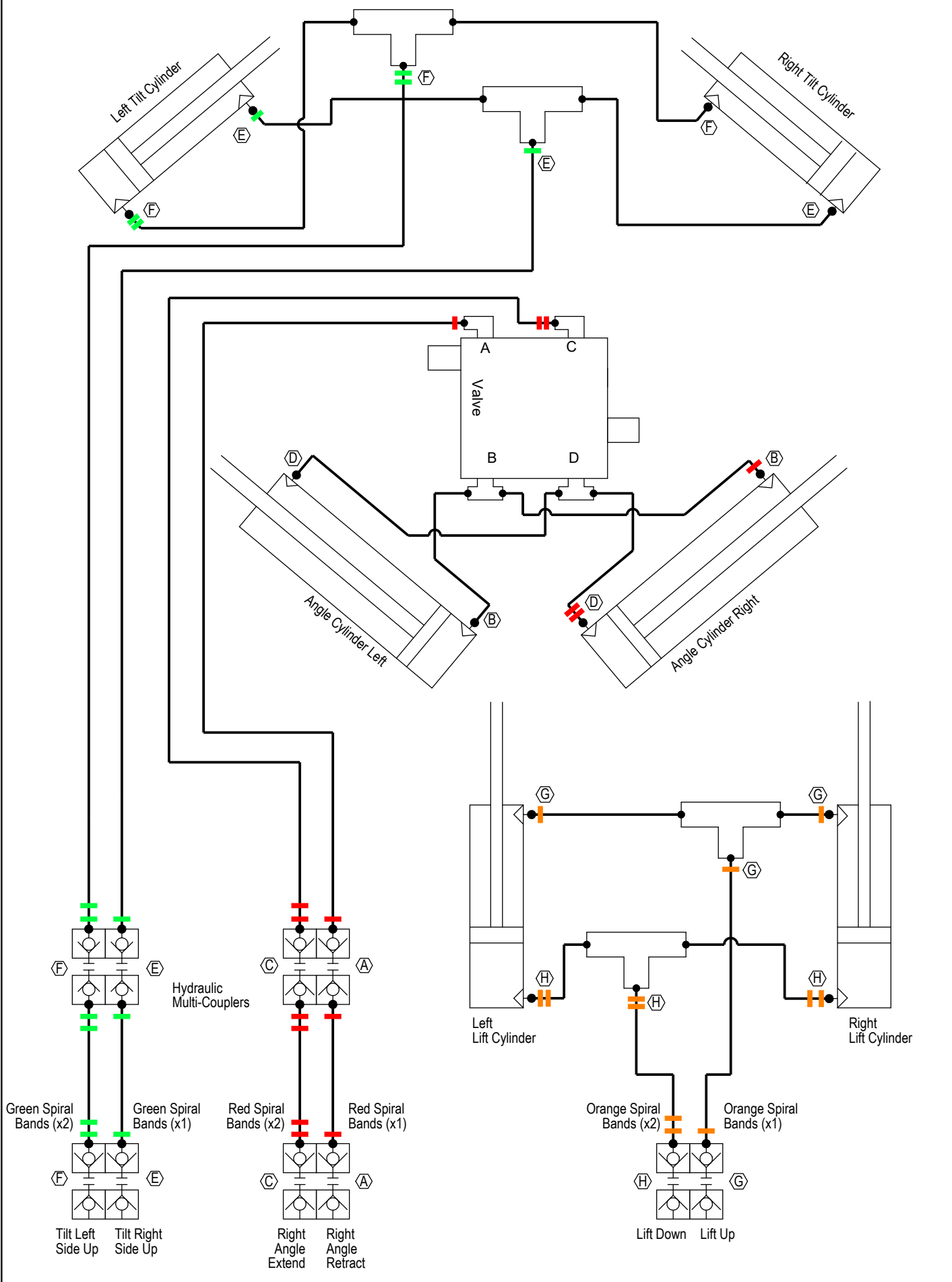

Tractor Service Valve

**Before Each Use:**

1. Disconnect the mobile half from the parking station and the cap from the fixed half.
2. Check that there is no contamination (salt, sand, dirt, etc.):
  - A. On the pins.
  - B. Inside the cam.
  - C. In the locking mechanism area.
  - D. On the face of the plates and couplings.
3. In case of contamination, remove it with a cloth and/or compressed air.
4. Check that there is still a lubricant/anti-corrosion (grease or silicone - see Note 1):
  - A. On the pins.
  - B. Inside the cam.
  - C. In the locking mechanism area.
5. Connect the mobile and fixed halves together.

**Fixed Half**

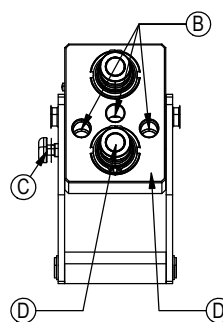

**Mobile Half**

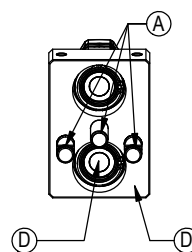

**After Each Use:**

1. Disconnect the mobile half from the fixed half.
2. Clean all contamination (salt, sand, dirt, etc.) from the following areas:
  - A. On the pins.
  - B. Inside the cam.
  - C. In the locking mechanism area.
  - D. On the face of the plates and couplings.

\*Use a cloth or compressed air. It is advised to not use water to clean these surfaces
3. Apply a lubricant/anti-corrosion (grease or silicone - see Note 1):
  - A. On the pins.
  - B. Inside the cam.
  - C. In the locking mechanism area.
4. Connect the cap to the fixed half and the mobile half to the parking station.

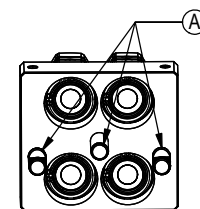
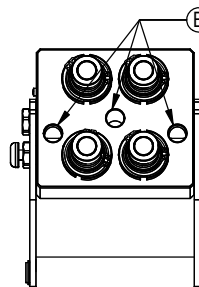

**Note 1:**

When sand and salt are present, or the plates under go a washdown, a heavy duty silicone spray lubricant should be used to replace grease from the factory. The lubricant should help protect from corrosion without collecting dust and contaminants, and will resist washing off when exposed to water.

**Recommended Lubricant Brands:**

Fluid Film (Aerosol or Non-Aerosol), LPS-2 Heavy Duty Lubricant, or CRC 3-36.

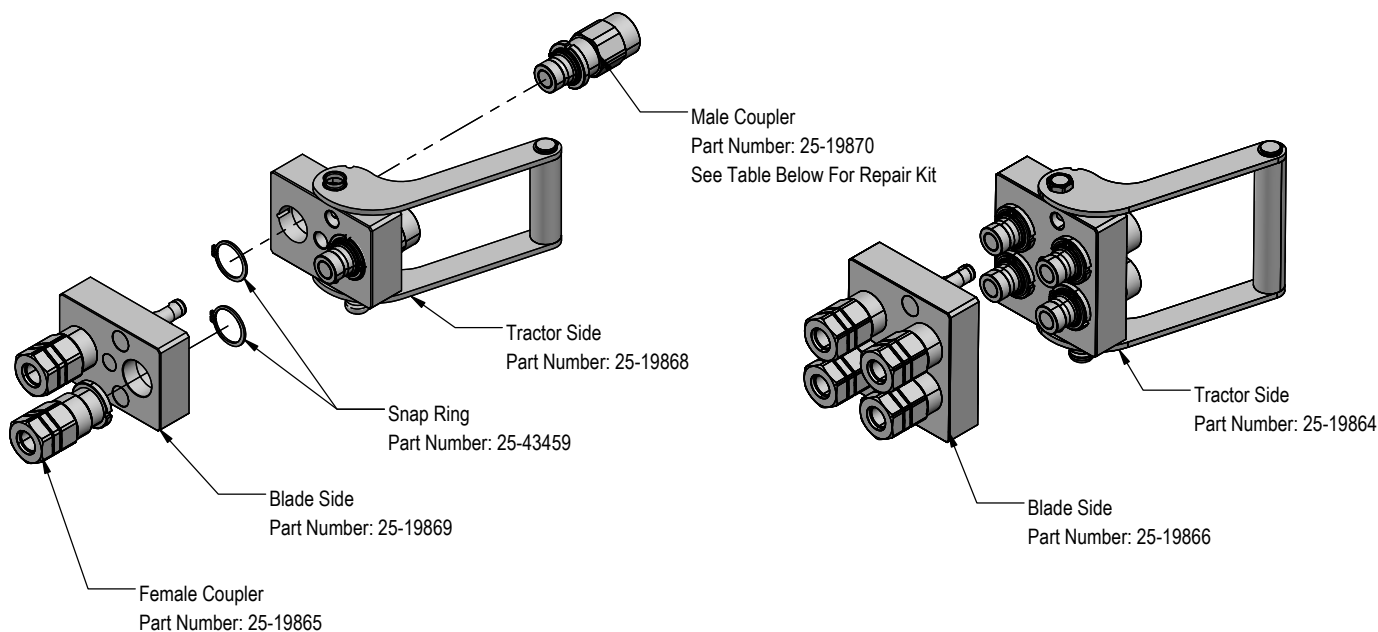

PN	Description
25-43425	Male Coupler O-Ring Repair Kit

**Cleaning The Male Interface Seal:**



1. Make sure the coupling is securely fastened into the plate or place in a vice.

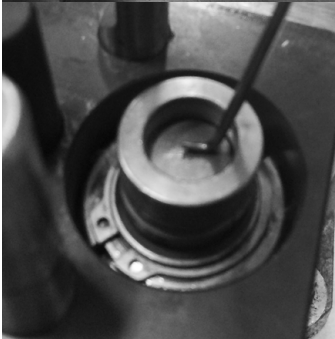

2. Using a blunt, non-marring tool, depress the valve face until the seal is exposed. Insert a bent metal wire between the valve face and the body of the coupling. Use caution not to damage or scratch the seal when inserting the wire.

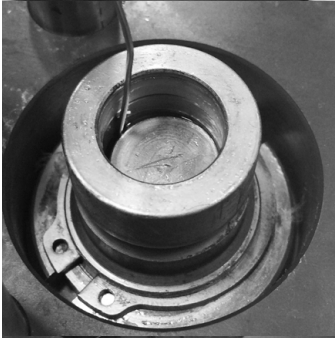

3. Inspect the seal and interior surfaces for contamination.

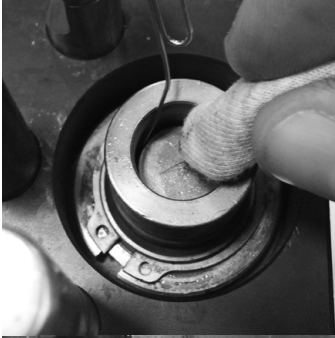

4. In case of contamination, carefully wipe surfaces with a soft cloth, or use compressed air to blow the contamination out. Do Not press hard on the seal as contamination can scratch the seal surface.

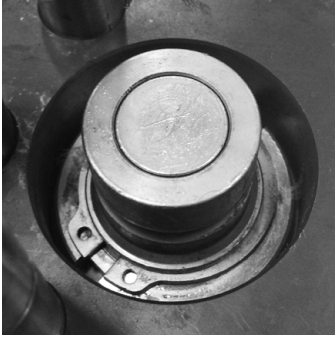

5. Using a non-marring tool, depress the valve face and remove the metal wire. Release the valve to the flush position.

**Cleaning The Female Bushing:**

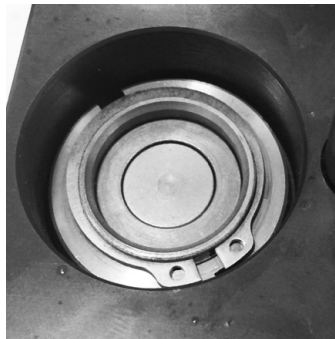

1. Make sure the coupling is securely fastened into the plate or place in a vice.



2. Using a non-marring tool, depress the outer ring to expose the bushing. There is no need to expose the valve seal, so stop pressing before the valve is opened.

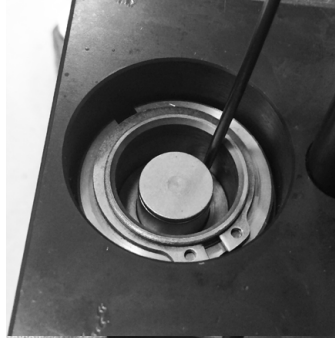

3. Inspect the interior body and bushing surfaces for contamination.

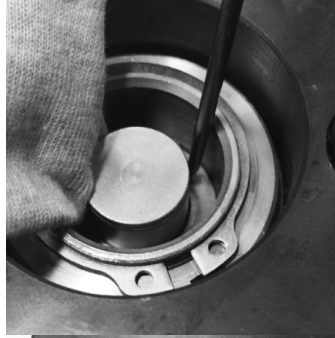

4. In case of contamination, carefully wipe surfaces with a soft cloth, or use compressed air to blow the contamination out.



5. Release the outer ring so that it returns to the flush position.

**MALE FAP - REPAIR KIT INSTRUCTIONS**

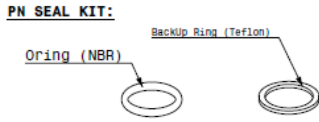
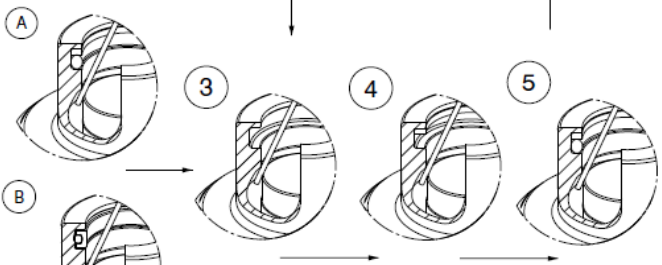
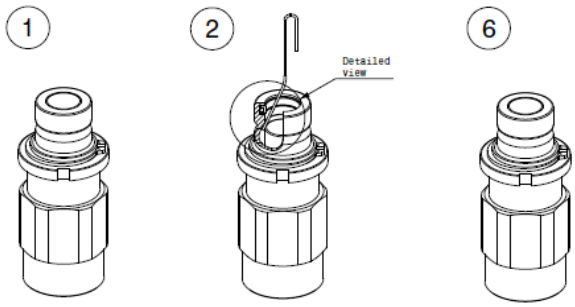

**DISASSEMBLING STEPS (see figures)**

1. Place the coupling in a vice.
2. Bend positioning clip as shown. Using a blunt, non marring object, depress valve face until seals are exposed. Insert the positioning clip between valve face and body, captivating the valve face
3. Using an O-ring pick or similar device, remove the seal from retaining groove. Clean properly the retaining groove with a clean cloth.

**Note:** Some M FAP are originally assembled with different seal technologies (see figures A and B ) but both used O-ring and backUp ring as replacement kit.

**ASSEMBLING STEPS (see figures)**

4. Insert the backup ring (4) in the seat and even with the use of a non sharpen tool. Place the BackUp ring on the superior shoulder of the seat in order to leave space for the O-ring (see figure 4).
5. Lubricate the O-ring with a fluid compatible with the seals compound. **Warning: using non compatible fluid would compromise the efficiency of the coupling.**
6. Push the piston with a blunt, non marring tool and take the metal clip out. Release the piston.

**FUNCTIONING CHECK**

Assemble the male coupling with the female in order to check the functioning and check for leaks.

**BY REPLACING THE SEALS, YOU REMOVE THE WARRANTY AND BECOME RESPONSIBLE FOR THE SAFETY AND THE EFFICIENCY OF THE COUPLING!**

**Leaking When Connected:**

1. Male Coupler is the issue despite leakage visually appearing from either top or bottom of female coupler sleeve, the seal between the two halves is made from the male interface seal.
2. Root cause typically is contamination. Can be identified by pushing in piston on male and exposing male seal. If dirty, can be wiped clean and reconnected to test seal. Can also be cut or extruded either from contamination or dynamic pressure in circuit while connection/disconnection.
3. The male coupler can be completely replaced, or a cost-effective approach would be replacing with available O-Ring seal kits (See O-ring Repair Instruction on Page 24).

**Leaking When Disconnected:**

1. Leaking/weeping at face of male coupler - See Above.
2. Leaking/weeping at face of female coupler - Root cause is contamination creating a leak path on the valve stem seal. This may be viewed/cleaned/cleared by exposing the seal. This is done by pushing in the inner ring bushing with a flat head screwdriver or similar tool. Once pressed in, it will stop at the next spring point that opens the valve. Pressing with additional force on the tool will open the valve and expose the sealing area which is underneath the valve. If the seal is damaged or extruded and cleaning does not fix the leakage, a new female coupler is best option. Seal kits are not available.

# Improvements

---

---

Grouser Products Inc. is continually striving to improve its products. We reserve the right to change prices, specification, or equipment at any time without notice. We also reserve the right to make improvements or changes when it becomes practical and possible to do so without incurring any obligation to make changes or additions to the equipment sold previously.

## Warranty

---

---

Grouser Products warrants to the original purchaser of each item that the product be free from defects in material and workmanship under normal use and service for a period of **two (2) years for Agriculture Series Blades and one (1) year for Heavy Duty Series from date of original retail delivery.**

### **The obligation of the consumer under this warranty:**

1. To read the operators manual and to operate, lubricate, maintain and store equipment in accordance with the instructions listed in the operators manual.
2. To inspect equipment and if any part needs repair or replacement when continued use would cause damage or wear to other parts or safety.
3. All equipment or parts claimed to be defective in material or workmanship must be made available for inspection at the place of business of a dealer authorized to handle the equipment covered by this warranty, or, upon request by Grouser Products, shipped to the Grouser Products factory in West Fargo, North Dakota.

### **The obligation of the dealer under this warranty:**

1. Complete warranty registration form and submit within 30 days of sale.
2. Contact Grouser Products for authorization prior to performing any warranty repairs or part replacement.
3. Complete warranty request form and submit with photos and supporting documentation.

### **The obligation of Grouser Products under this warranty:**

1. Repair or replace, any equipment or parts, in the judgment of Grouser Products to be defective in material or workmanship.
2. Grouser Products will cover the cost of parts and ground shipping at dealer invoice only.
3. Grouser Products shall have no obligation to bear the cost of labor or transportation in connection with replacement or repair of any such defective parts.

### **This warranty does not cover:**

1. Depreciation or damage caused by normal wear, accident, improper assembly, improper adjustments.
2. Improper maintenance including lack of proper lubrication, or improper use. Including loose bolts, nuts, or fitting due to over tightening or vibration after 20 hours of operation.
3. Repairs or alterations without authorization from a Grouser Products representative.
4. Grouser Products shall have no liability if the equipment has been altered or reworked without the written authorization of Grouser Products.

Grouser Products' parts, which are furnished under this warranty and properly installed, shall be warranted to the same extent as the original parts under this warranty if, and only if, such parts are found to be defective within the original warranty period covering the original equipment.

**NO EMPLOYEE OR REPRESENTATIVE OF GROUSER PRODUCTS IS AUTHORIZED TO CHANGE THE WARRANTY IN ANY WAY OR GRANT ANY OTHER WARRANTY.**

## Contact Us

---

---

As always, if you have any questions about your system or other products made by Grouser, feel free to contact us.



755 2nd Ave NW - West Fargo, ND 58078  
+1 701-282-7710 | info@grouser.com  
www.grouser.com